

AERODROME BEACON



AERONAUTICAL BEACONS

AERODROME BEACON

KEY FEATURES

- Based on LED technology
- >2.000cd flashing WHITE, night mode
- Long life time >10 years life expectancy
- Low consumption
- Stabilised light output
- Lightweight and compact
- Low wind load factor
- Alarm/remote status control
- Easy to install
- No RF-radiations
- Light output alignment device
- Power supply AC
- Patented beacon (EU 001929910-0001; Canada 145 189; USA D673,474; Turkey TR2012 05662)

OPTICAL FEATURES

- Horizontal beam radiation 360°
- Vertical beam spread -3° to +1°
- PMMA lens
- 20fmp to 30fpm

OPTIONS

- Beacon support bracket
- Power supply DC
- Top wind deflector
- GPS (Global Position System) syncro
- White/Yellow alternate flashes for water aerodromes
- White/Green alternate flashes for land aerodromes instead of white flashes only

ELECTRICAL FEATURES

- Average power consumption up to 100W
- Range section of connectable conductors: 0,5mm² to 2,5mm²
- Cable outer diameter range: 7mm to 14mm
- LED feeded at constant current
- Lightning protection

MECHANICAL FEATURES

- Anodised aluminium body with heat-sink for natural draft air cooling
- Aviation yellow painted aluminium body lamp
- Bottom wind collector for central heat-sink cooling
- Borosilicate glass cover protection
- Silicon gasket
- Wind resistance tested at 240km/h (150mph)
- Vibration resistance up to: 80m/s² (10° Mercalli Intensity Scale / 7° Richter Magnitude Scale)
- Degree of protection: IP65
- Operating temp.: -20°C to +45°C
- Lamp unit weight: 7kg

APPLY TO

- Airports intended for use at night and that can not be easily identified from the air by other means.
- Used to generally identify the presence of an aerodrome.

CERTIFICATIONS

- CE marking

COMPLIANCE

- ICAO Aerodromes -Annex 14 Volume 1, Par. 5.3.3 "Identification Beacon"

PART NUMBER

- Part number:
ADB-LXS-230VAC
ADB-LXS-24VDC

AERONAUTICAL BEACONS

AERODROME BEACON

BEACON FRONT VIEW

1ST LEVEL WHITE
2ND LEVEL WHITE

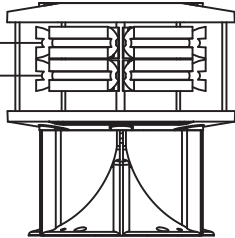

BEACON SIDE VIEW

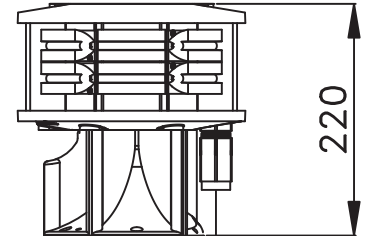

INCOMING POWER SUPPLY CABLE
C/W CONNECTOR (CABLE O.D. 7/14mm, Max size 2.5sqmm)

BEACON TOP VIEW

∅ 215

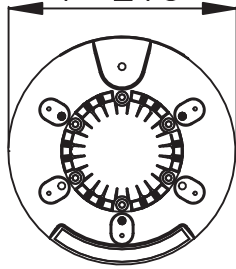

FIXING DETAILS

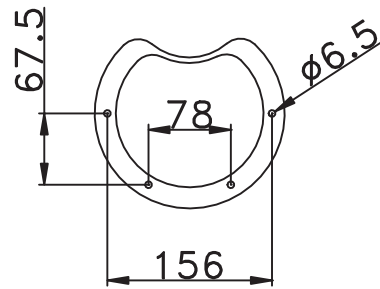

AERODROME BEACONS

CERTIFICATION



COMPLIANCE



FEATURES

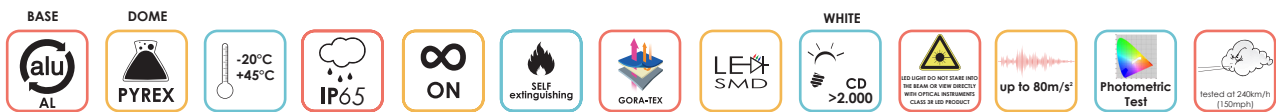

TYPICAL APPLICATION

