

## 5nM RED LIGHT Ex NIGHT MODE



HAZARDOUS AREA



# MARINE NAVIGATION AIDS

## 5nM RED LIGHT Ex NIGHT MODE TECHNICAL SPECIFICATIONS

### OPTICAL FEATURES

- Based on LED technology
- 5nM (nautical mile) night mode, red flashing (Morse Letter "U")
- Horizontal beam radiation 360°
- Vertical beam spread >2,5°
- PMMA lens

### MECHANICAL FEATURES

- Painted RAL 7035 aluminium body
- Borosilicate glass dome
- Degree of protection: IP66
- Operating temperature: -52°C to +60°C
- Lamp unit weight: 7kg
- ATEX marking:  
II 2GD Ex de IIC T4 Gb, Ex tb IIIC T135°C Db
- IECEx marking:  
Ex de IIC T4 Gb, Ex tb IIIC T135°C Db
- TRCU RU marking:  
1 Ex db e IIC T6...T3 GbX,  
Ex tb IIIC T135°C...T200°C Db X

### ELECTRICAL FEATURES

- Power supply AC or DC or from Luxsolar Control Panel
- Average power consumption for night mode: 4W
- LED feeded at constant current

### APPLY TO

- Oil&Gas platform  
Use as subsidiary light located to mark the horizontal extremities of the structure excepting those mark with white lights as well as interconnecting bridges.

### CERTIFICATIONS

- ATEX certificate
- IECEx certificate
- TRCU certificate
- CE marking
- IALA Maritime Buoyage System (MBS)
- IALA Recommendation O-139

### PART NUMBER

- Part number:
  - ▶ **MNL-LXS-5nM-Ex-230VAC**
  - ▶ **MNL-LXS-5nM-Ex-24VDC**

# MARINE NAVIGATION AIDS

## 5nM WHITE LIGHT Ex NIGHT MODE TECHNICAL DRAWINGS

BEACON FRONT VIEW

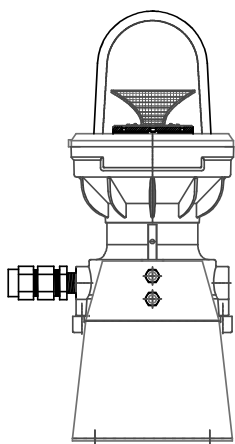

BEACON SIDE VIEW

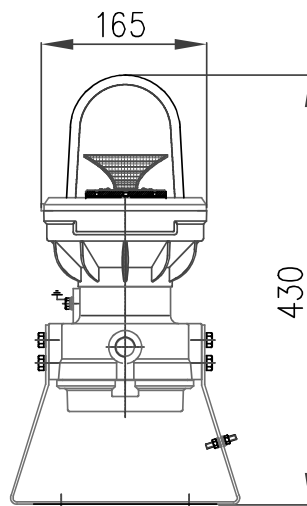

BEACON TOP VIEW

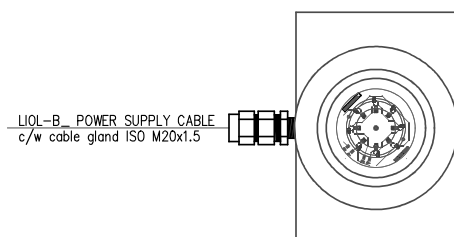

FIXING DETAILS

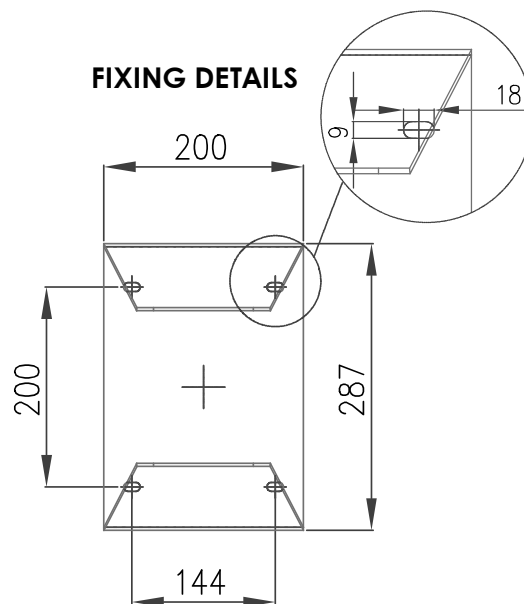

# MARINE NAVIGATION AIDS

## 5nM RED LIGHT Ex NIGHT MODE

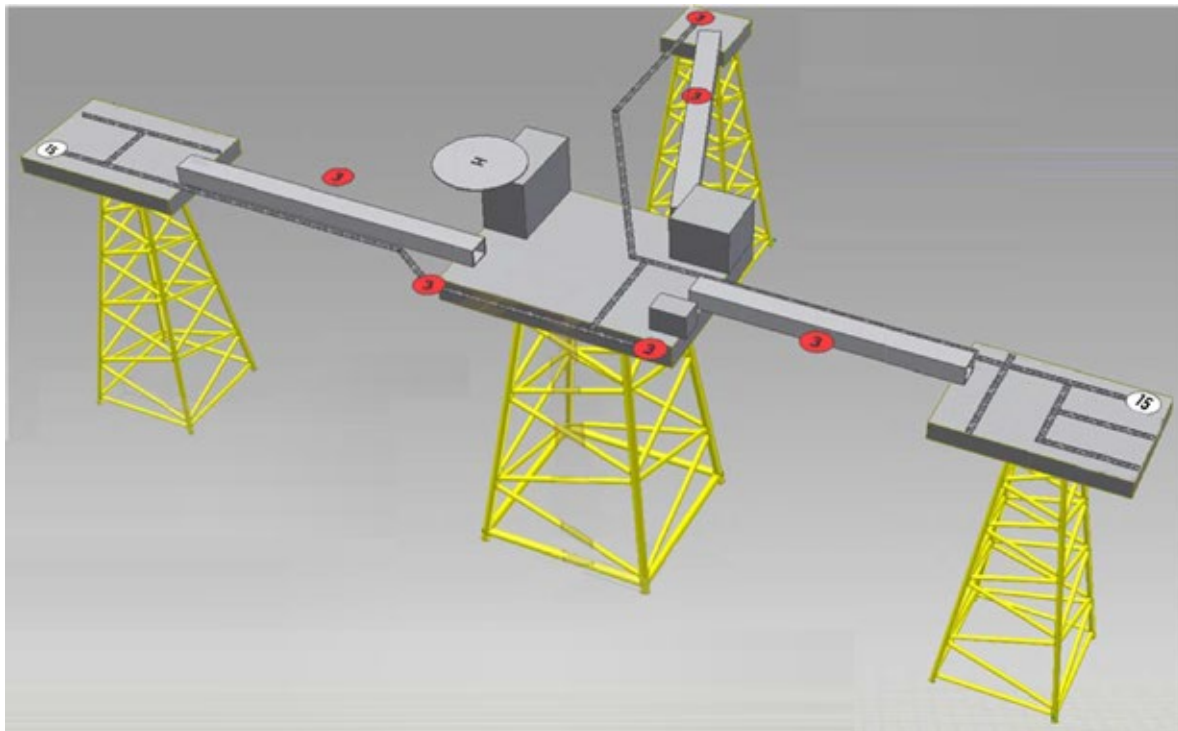

### LEGEND

5 5nM - Red

### CERTIFICATIONS



### FEATURES



### TYPICAL APPLICATION

