

OMNI - DIRECTIONAL APPROACH LIGHTING SYSTEM (ODALS)



According to FAA Advisory Circular 150/5345-51, ODALS system is composed by five omni-directional flashing lights installed on extended runway centerline and two REIL omni-directional light installed at each side of runway threshold.

The five lights flash in sequence toward the runway threshold and the two REIL lights flash simultaneously after the last flash of the centerline lights.



FAA AERONAUTICAL BEACONS

ODALS

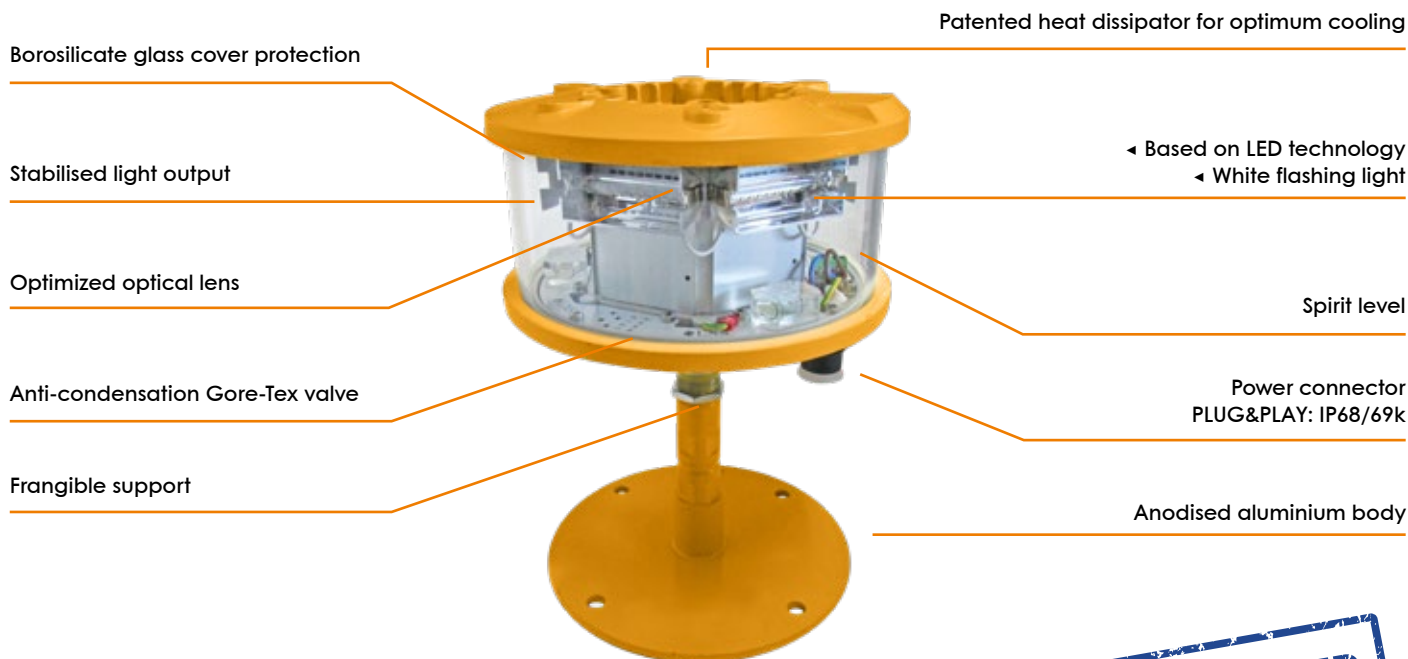

NOTE: electronic beacon driver in a separate enclosure

IP66

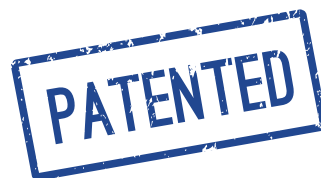

LUXSOLAR L859-LXS ODALS Light is compliant to FAA rule.

With a compact body, high quality and ultra-bright LEDs, customized lenses and patented shape for optimum light emission and beacon cooling LUXSOLAR L859-LXS product is the most up-to-dated and technologically advanced Approach Light Beacon.

This LED device is designed to not contain any electronic component (that is available in a separate control local panel): a huge advantage in terms of increased life-time and suitability to all environments (beacons can stand extreme weather conditions) and in terms of an easy maintenance (in case of maintenance or periodic checks on electronic components, these can be done at ground or easily accessible levels).

CERTIFICATION



COMPLIANCE

FAA

FEATURES



TYPICAL APPLICATION



FAA AERONAUTICAL BEACONS

ODALS TECHNICAL SPECIFICATIONS

OPTICAL FEATURES

- Based on LED technology
- WHITE light
- Three intensity steps: 5.000cd, 1.500cd, 300cd, flashing at @60fpm (style F)
- Horizontal beam radiation 360°
- Vertical beam spread from 2° to 10°
- PMMA lens
- Light output alignment device

MECHANICAL FEATURES

- Anodised aluminium body, painted yellow
- Borosilicate glass cover protection
- Silicon rubber, VMQ
- Base wind collector and internal heat sink for optimum cooling
- Frangible support
- Degree of protection: IP66
- Operating temperature: -30°C +50°C
- Lamp unit weight: 8kg

BOX MECHANICAL FEATURES

- Enclosure material: mild steel, painted RAL 7035
- Surge arrester
- Fault alarm
- Photocell (twilight sensor)
- Overvoltage protection

ELECTRICAL FEATURES

- Suitable for 24Vdc or 115/230Vac power supply by LUXSOLARcontroller box
- LED feeded at constant current
- No RF-radiations

APPLY TO

- Airport runways

CERTIFICATIONS

- CE marking

COMPLIANCE

- FAA AC150/5345-51

PART NUMBER

- L859-LXS-8

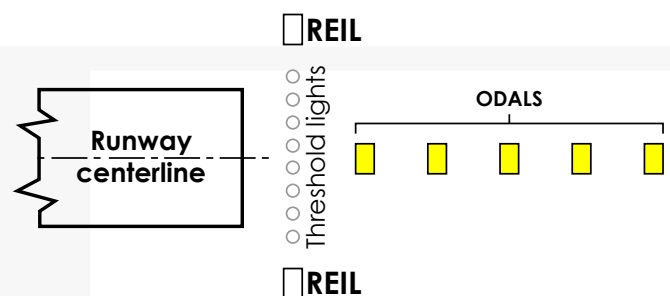

FAA AERONAUTICAL BEACONS

ODALS TECHNICAL DRAWING

BEACON DETAIL

BEACON SIDE VIEW

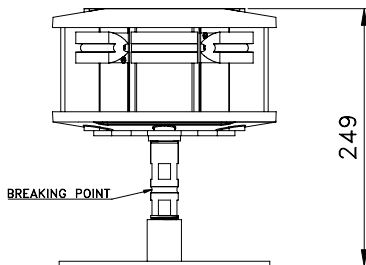

BEACON FRONT VIEW

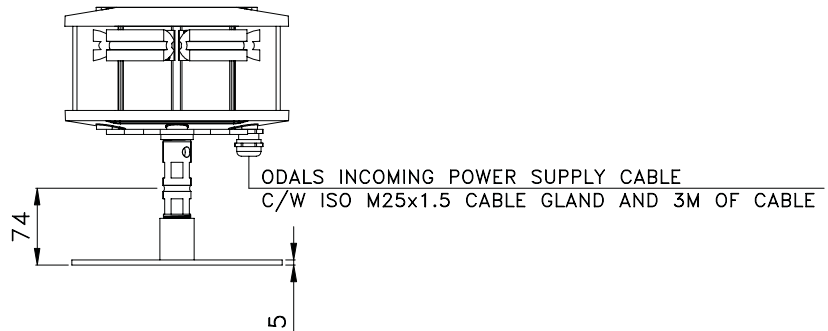

BEACON TOP VIEW

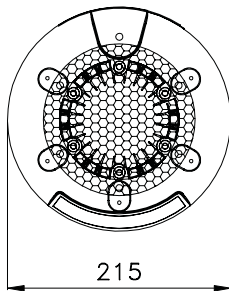

FIXING DETAILS

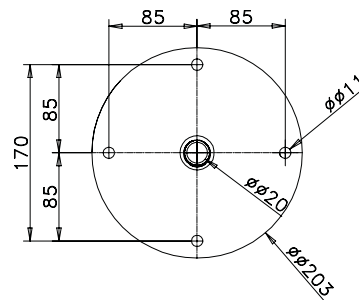

PANEL DETAIL

FRONT VIEW

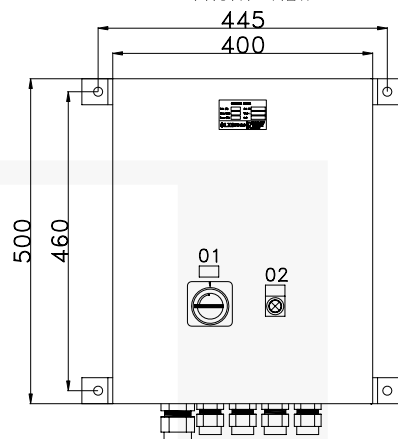

SIDE VIEW

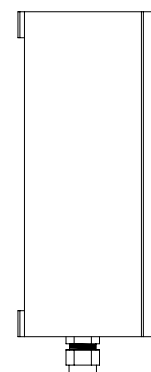

REMOTE COMMAND SIGNALS CABLE
C/W CABLE GLAND ISO M25x1.5
ALARMS SIGNALS CABLE
C/W CABLE GLAND ISO M25x1.5
INCOMING POWER SUPPLY CABLE
C/W CABLE GLAND ISO M32x1.5

REIL-1 BEACON POWER SUPPLY CABLE
C/W CABLE GLAND ISO M25x1.5
REIL-2 BEACON POWER SUPPLY CABLE
C/W CABLE GLAND ISO M25x1.5

BOTTOM VIEW

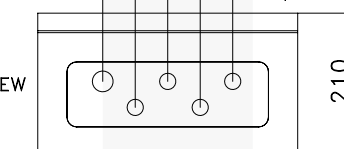

NOTE: typical drawing for control panel