

# LOW INTENSITY

## SS316 LOW INTENSITY OBSTRUCTION LIGHT CAP168 - GROUP A



As specified by CAP 168 'Licensing of Aerodromes', Low Intensity Obstruction Lights have to be used to warn the presence of obstacles up to 45m height.

This beacon is the simplest device according to CAP 168 standards. It provides steady burning red light with two types of intensity: **≥10cd** for **Group A Ex**.

Low intensity obstacle lights **Group A Ex** have to be used to light obstacles on the aerodrome movement area or when **LIOL Group B Ex** may cause dazzle.



# LOW INTENSITY

## SS316 LIOL GROUP A Ex LOW INTENSITY OBSTRUCTION LIGHT



LUXSOLAR L810-LXS-Ex Low Intensity Obstruction Light Group A is compliant to CAP 168 'Licensing of Aerodromes', and ATEX - IECEx certified.

The light fixture is designed for hazardous areas Zone 1/21, 2/22 with Ex db IIC and Ex tb IIIC protection, compliant to EN/IEC60079-0, EN/IEC60079-1 and EN/IEC60079-31 standards.

With a compact body, high quality and **ultra-bright LEDs**, **optical reflector for an optimum beam spread**, LUXSOLAR L810-LXS-Ex-SS product is **your best choice for an efficient, long life and reliable Aircraft Warning Obstacle Light**.

### CERTIFICATION



### COMPLIANCE



### FEATURES



### TYPICAL APPLICATION



# LOW INTENSITY

## SS316 LIOL GROUP A Ex TECHNICAL SPECIFICATIONS

### OPTICAL FEATURES

- Based on LED technology
- RED light - Steady Burning
- LIOL Group A Ex: >10 cd
- Cd emission: +6° e +10°
- Horizontal beam radiation: 360°
- Vertical beam spread 0° to +30°
- Optical reflector

### MECHANICAL FEATURES

- SS316 natural finish body
- Borosilicate glass dome
- Degree of protection: IP66
- Operating temperature: -40°C to +70°C
- Lamp unit weight: 7kg
- ATEX marking:  
II 2GD Ex d IIC T4 ~ T6 Gb,  
Ex tb IIIC T135°C ~T85°C
- IECEx marking:  
Ex d IIC T4 ~ T6 Gb, Ex tb IIIC T135°C ~T85°C

### ELECTRICAL FEATURES

- Power supply AC or DC or from Luxsolar Control Panel
- Average power consumption for LIOL GROUP A Ex (steady burning): 6W
- LED fedded at constant current

### ORDER CODE

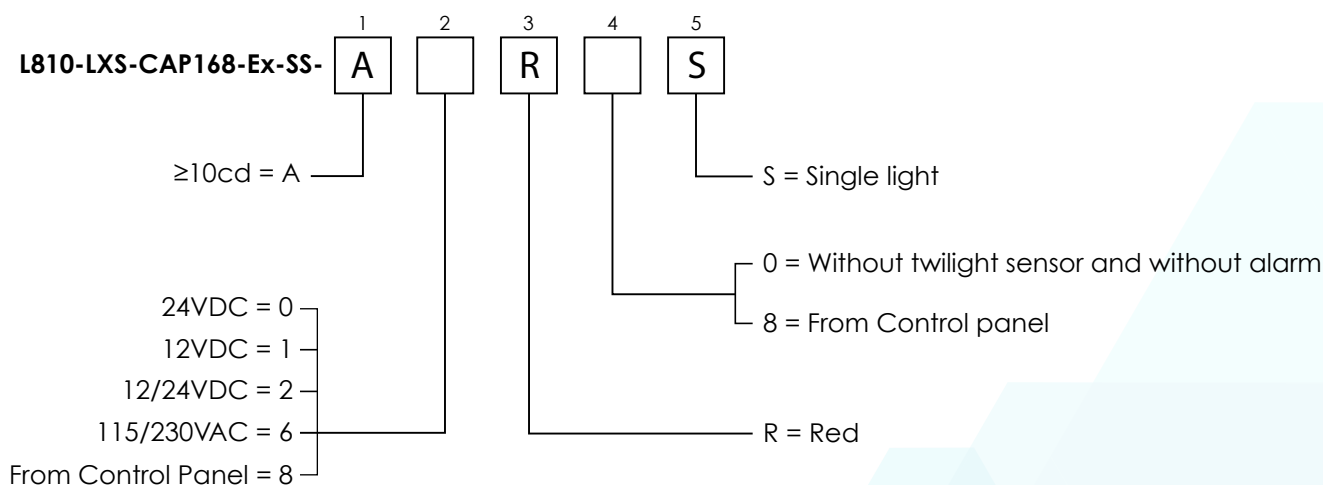

### APPLY TO

- Stack
- Chimney
- Tower crane
- Offshore Platform
- Chemical and petrochemical plant

### CERTIFICATIONS

- ATEX certificate
- IECEx certificate
- CAP168 test report (EN 17025 approved laboratory) nr. 1044-QL18-R04
- CE marking

### COMPLIANCE

- CAP168 Licensing of Aerodromes, Ch. 4: The Assessment and Treatment of Obstacles
- CAP437: Chapter 4th "Visual Aids"

# LOW INTENSITY

## SS316 LIOL GROUP A Ex TECHNICAL SPECIFICATIONS

TOP VIEW

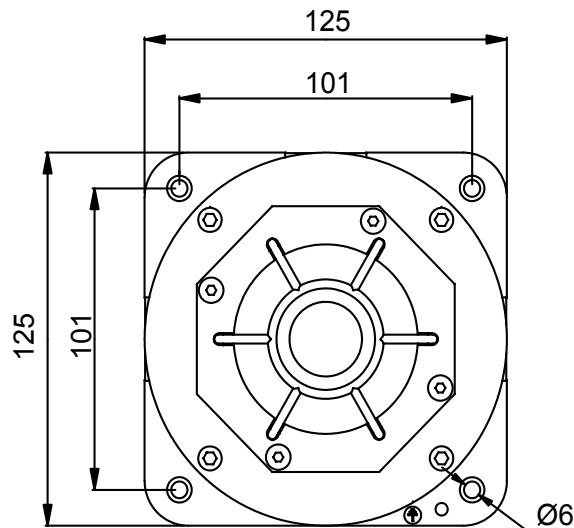

LATERAL VIEW

