

# HELIPORT LIGHTS

## FLIGHT PATH ALIGNMENT GUIDANCE LIGHT INSET FPAG-LXS-INSET



Where practicable, a flight path alignment guidance marking should be provided to indicate available approach and/or departure path directions.

- **Steady burning WHITE light**
- Long life time >10 years life expectancy
- Low consumption
- Stabilised light output
- Easy to install
- No RF-radiations
- Compact and light structure

**PATENTED**

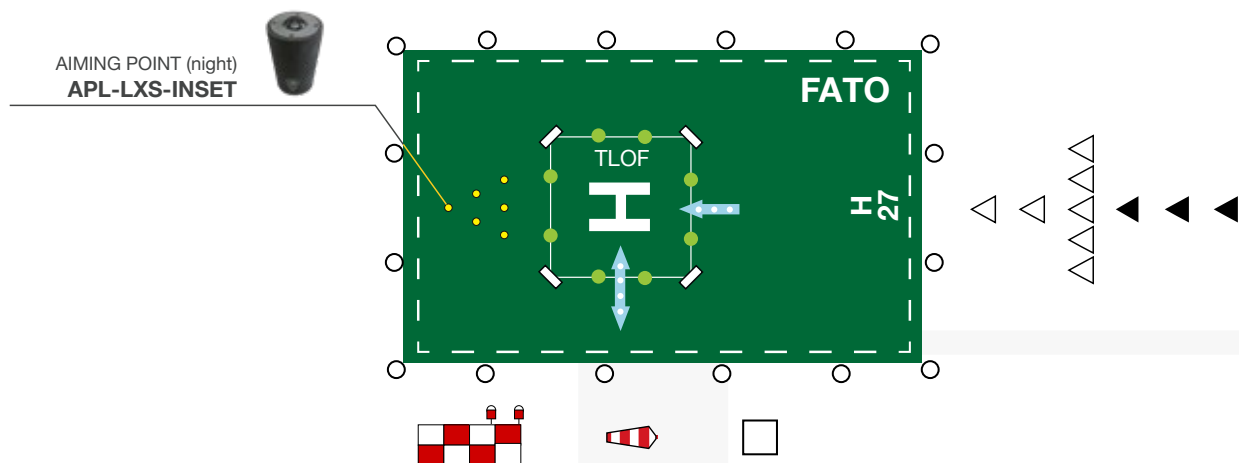

### CERTIFICATION



### FEATURES



### TYPICAL APPLICATION



# HELIPORT LIGHTS

## FLIGHT PATH ALIGNMENT GUIDANCE LIGHT INSET TECHNICAL SPECIFICATION AND DRAWING

### OPTICAL FEATURES

- Horizontal emission: 360°
- PMMA and tempered glass lens

Elevation (E)	Luminous Intensity
$20^{\circ} < E \leq 90^{\circ}$	3 cd
$13^{\circ} < E \leq 20^{\circ}$	8 cd
$10^{\circ} < E \leq 13^{\circ}$	15 cd
$5^{\circ} < E \leq 10^{\circ}$	30 cd
$2^{\circ} \leq E \leq 5^{\circ}$	15 cd

-180° Azimuth +180°

### MECHANICAL FEATURES

- SS316 body
- NBR o-ring
- Tempered glass max load 5 ton.
- Degree of protection: IP68 (1,2mx45min)
- Shallow base dimension: 5"
- Operating temperature: -20°C to +60°C
- Lamp unit weight c/w shallow base 4,8kg

### COMPLIANCE

- ICAO Aerodromes - Annex 14 Volume 2, Heliports
- EASA CS-HPT-DSN

### ELECTRICAL FEATURES

- Power Supply:
  - 24 VDC stand-alone version
  - From control panel for light system
- Consumption: 3,7W @12/24Vdc
- Constant current driven LED
- Light intensity adjustment: 10% - 30% - 100%

### OPTIONS

- 8" / 12" shallow base adapter
- IR wavelength 850nm, compatible with NVG pilot

### CERTIFICATIONS

- ICAO/EASA test report (EN17025 laboratory) nr. 1407-QL22-R04
- CE marking

### ORDER CODE

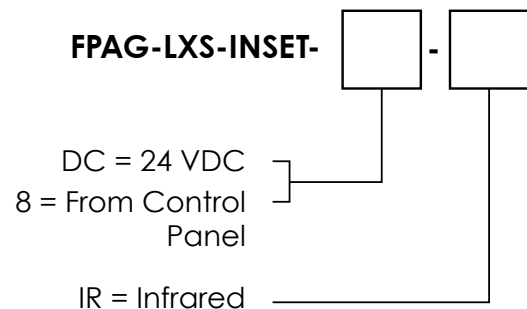

## TECHNICAL DRAWINGS

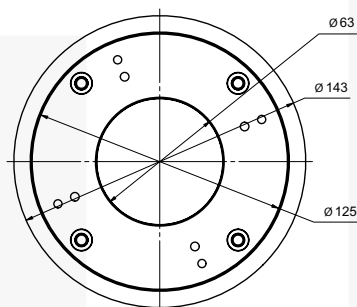

### SIDE VIEW

