

# HELIPORT LIGHTS

## PERIMETER LIGHT - FATO INSET FATO-LXS-INSET



**PATENTED**

Installed at the edges of the FATO AREA, defining its perimeter. It has a recessed and driveway structure that requires the construction of a well inside the flooring of the surface. Alternatively, it is possible to install the product code PHL-LXS-FATO or FATO-LXS-FLT.

- Steady white light
- Lifetime higher than 10 years
- Low consumption
- Stabilised light output
- Compact and light structure
- Easy to install
- No RF-radiations

## INSTALLATION MAPS

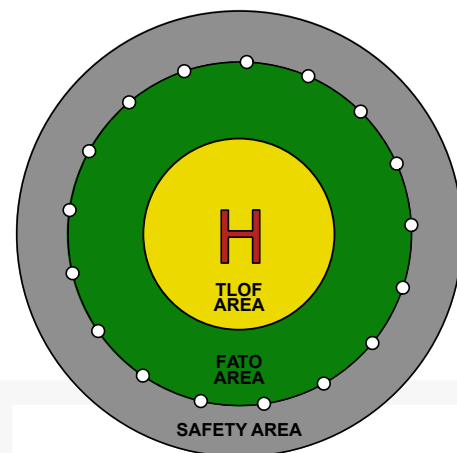
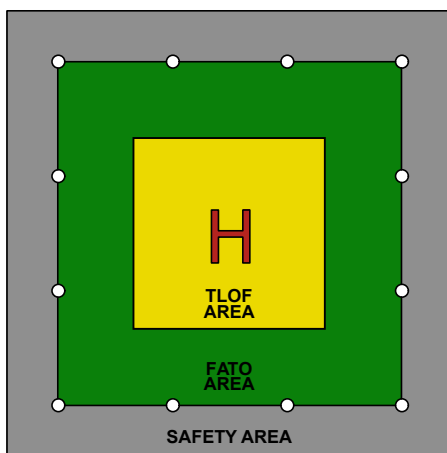

### LEGEND

○ PHL-LXS-FATO

NOTE: for HEMS elevated surfaces, the FATO area coincides with TLOF area therefore, in the major part of installations, FATO perimeter lights are not provided.

### CERTIFICATION



### FEATURES



# HELIPORT LIGHTS

## PERIMETER LIGHT - FATO INSET TECHNICAL SPECIFICATION

### OPTICAL FEATURES

- Horizontal emission: 360°
- PMMA and tempered glass lenses

Elevation (E)	Luminous Intensity
30°	10 cd
25°	50 cd
20°	100 cd
10°	
3°	
0°	10 cd

-180° Azimuth +180°

### MECHANICAL FEATURES

- SS316 body
- NBR o-ring
- Degree of protection IP68 (1,2mx45min)
- Shallow base 5"
- Operating temperature: -20°C to +60°C
- Supplied with 30cm LUXSOLAR standard cable
- Weight: 4,8 Kg
- Tempered glass max load 5 ton

### COMPLIANCE

- ICAO Aerodromes - Annex 14 Volume 2, Heliports
- EASA CS-HPT-DSN

### ELECTRICAL FEATURES

- Power Supply:
  - 24 VDC stand-alone version
  - From control panel for light system
- Consumption: 3,7W @12/24Vdc
- Constant current driven LED
- Light intensity adjustment: 10% - 30% - 100%

### OPTIONS

- Adaptor for shallow base 8"/ 12"
- IR wavelength:  
850nm, compatible with NVG pilot

### CERTIFICATION

- CE marking
- ICAO/EASA test report 1407-QL22-R04 (lab. EN17025)

### ORDER CODE

**FATO-LXS-INSET-**

DC = 24 VDC  
8 = From Control  
Panel

IR = Infrared

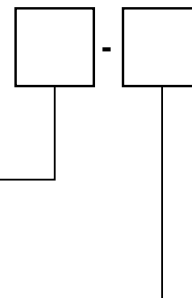

## TECHNICAL DRAWINGS

TOP VIEW

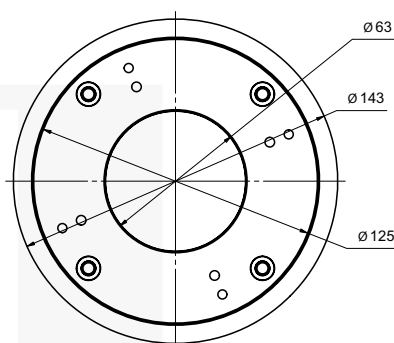

SIDE VIEW

