

HELIPORT LIGHTS

PERIMETER LIGHT - FATO INSET FATO-LXS-INSET



PATENTED

Installed at the edges of the FATO AREA, defining its perimeter. It has a recessed and driveway structure that requires the construction of a well inside the flooring of the surface. **Alternatively, it is possible to install the product code PHL-LXS-FATO or FATO-LXS-FLT.**

- **Steady white light**
- Lifetime higher than **10 years**
- **Low** consumption
- **Stabilised light** output
- **Compact** and **light structure**
- **Easy** to install
- **No RF-radiations**

INSTALLATION MAPS

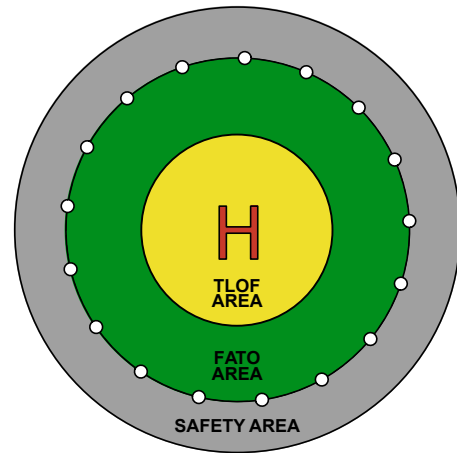
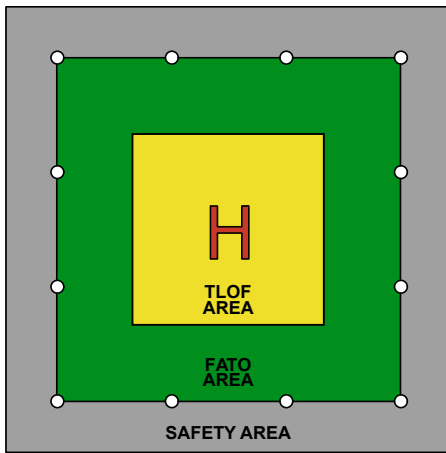

LEGEND

○ PHL-LXS-FATO

NOTE: for HEMS elevated surfaces, the FATO area coincides with TLOF area therefore, in the major part of installations, FATO perimeter lights are not provided.

CERTIFICATION



FEATURES



HELIPORT LIGHTS

PERIMETER LIGHT - FATO INSET TECHNICAL SPECIFICATION

OPTICAL FEATURES

- Horizontal emission: 360°
- PMMA and tempered glass lenses

Elevation (E)	Luminous Intensity
30°	10 cd
25°	50 cd
20°	100 cd
10°	
3°	
0°	10 cd

-180° Azimuth +180°

MECHANICAL FEATURES

- SS316 body
- NBR o-ring
- Degree of protection IP68 (1,2mx45mm)
- Shallow base 5"
- Operating temperature: -20°C to +60°C
- Supplied with 30cm LUXSOLAR standard cable
- Weight: 4,8 Kg
- Tempered glass max load 5 ton

ELECTRICAL FEATURES

- Power supply only from control panel (12/24/48 Vdc or 115/230Vac)
- Consumption: 3,7W @12/24Vdc 4W
- Constat current driven LED
- Light intensity adjustment: 10% - 30% - 100%

OPTIONS

- Adatptor for shallow base 8" / 12"
- IR wavelength: 850nm, compatible with NVG pilot

CERTIFICATION

- CE marking
- ICAO/EASA test report 1407-QL22-R04 (lab. EN17025)

COMPLIANCE

- ICAO Aerodromes - Annex 14 Volume 2, Heliports
- EASA CS-HPT-DSN

ORDER CODE

FATO-LXS-INSET-8

TECHNICAL DRAWINGS

TOP VIEW

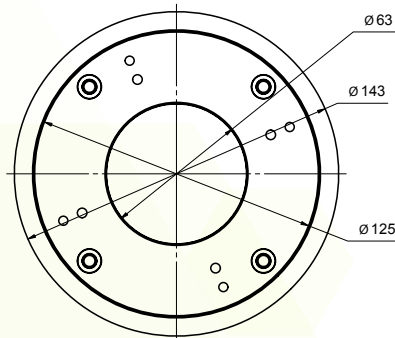

SIDE VIEW

