

## CIRCLING GUIDANCE LIGHT



According to **Annex 14 of ICAO regulations**, Circling Guidance Lights should be provided at airports if the existing approach or runway lighting does not allow easy identification of the runway. The light displays white flashing light.



# ICAO AERONAUTICAL BEACONS

## CIRCLING GUIDANCE LIGHT

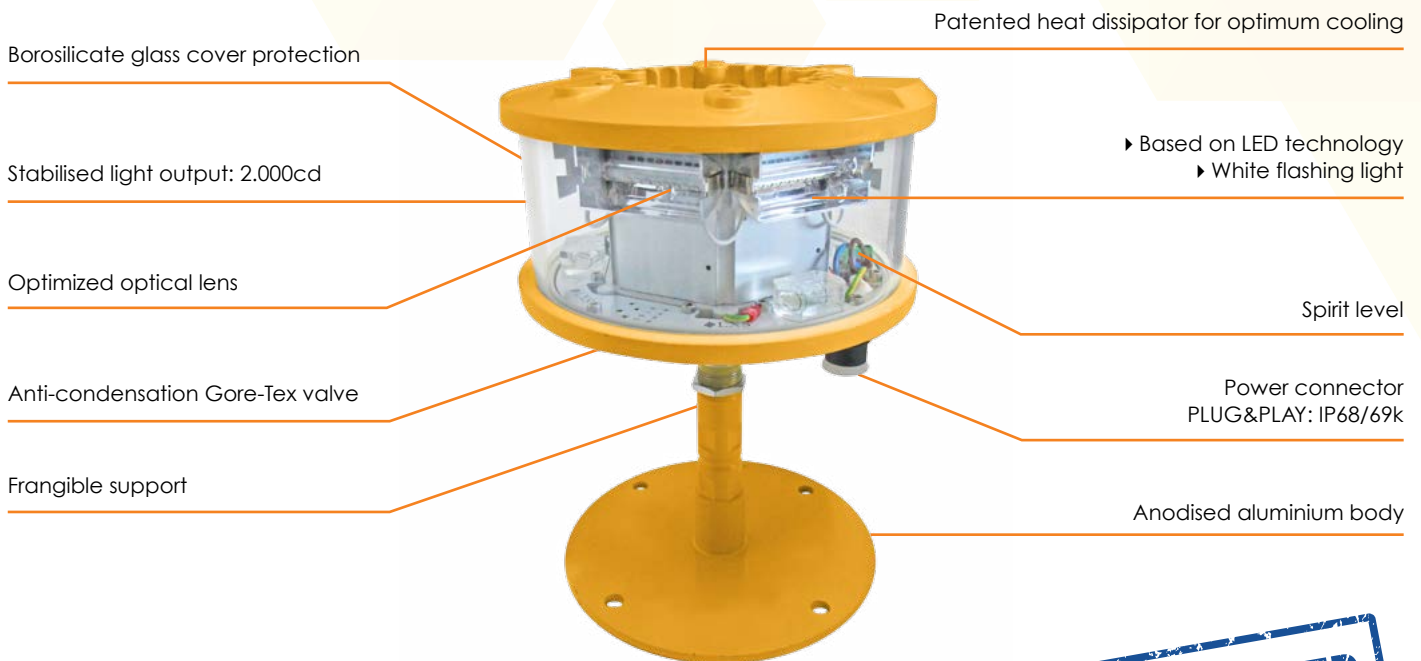

**NOTE: electronic beacon driver in a separate enclosure**

**IP66**



LUXSOLAR CGL-LXS Circling Guidance Light is **compliant to ICAO rule**.

With a compact body, high quality and **ultra-bright LEDs**, **customized lenses** and **patented shape for optimum light emission and beacon cooling** LUXSOLAR CGL-LXS product is the most **up-to-dated and technologically advanced Aeronautical Beacon**.

This LED device is designed to **not contain any electronic component** (that is available in a separate control local panel): a huge **advantage in terms of increased life-time and suitability to all environments** (beacons can stand extreme weather conditions) and in terms of an **easy maintenance** (in case of maintenance or periodic checks on electronic components, these can be done at ground or easily accessible levels).

### CERTIFICATION



### COMPLIANCE



### FEATURES



### TYPICAL APPLICATION



# ICAO AERONAUTICAL BEACONS

## CIRCLING GUIDANCE LIGHT TECHNICAL SPECIFICATIONS

### OPTICAL FEATURES

- Based on LED technology
- 5.000cd day mode, WHITE flashing \*
- 1.500cd twilight mode, WHITE flashing \*
- 600cd night mode, WHITE flashing \*
- Horizontal beam radiation 360°
- Vertical beam spread from 2° to 10°
- PMMA lens
- Light output alignment device

### MECHANICAL FEATURES

- Anodised aluminium body, painted yellow
- Borosilicate glass cover protection
- Silicon rubber, VMQ
- Base wind collector and internal heat sink for optimum cooling
- Frangible support
- Degree of protection: IP66
- Operating temperature: -30°C +50°C
- Lamp unit weight: 8kg

### BOX MECHANICAL FEATURES

- Enclosure material: mild steel, painted RAL 7035
- Surge arrester
- Fault alarm
- Photocell (twilight sensor)
- Overvoltage protection

### ELECTRICAL FEATURES

- Suitable for 24Vdc or 115/230Vac power supply by LUXSOLARcontroller box
- LED feeded at constant current
- No RF-radiations

### APPLY TO

- Precision approach runway intended for use by day or night when existing approach lighting systems do not satisfactorily permit identification of the runway.

### CERTIFICATIONS

- CE marking

### COMPLIANCE

- ICAO Aerodromes -Annex 14 Volume 1, Chapter 5
- ICAO Aerodrome Design Manual doc. 9157, part 4 Visual Aids, Chapter 7

### PART NUMBER

- **CGL-LXS-8**

**CIRCLING  
GUIDANCE  
LIGHT**

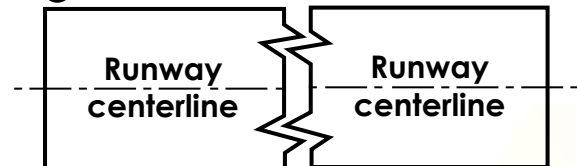

**CIRCLING  
GUIDANCE  
LIGHT**

\* for visibility 1.500m to 5.000m

# ICAO AERONAUTICAL BEACONS

## CIRCLING GUIDANCE LIGHT TECHNICAL DRAWING

### BEACON DETAIL

BEACON SIDE VIEW

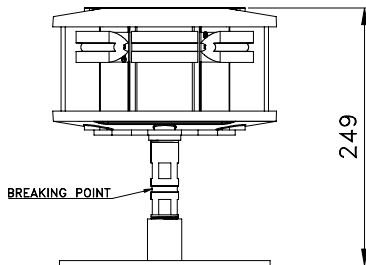

BEACON FRONT VIEW

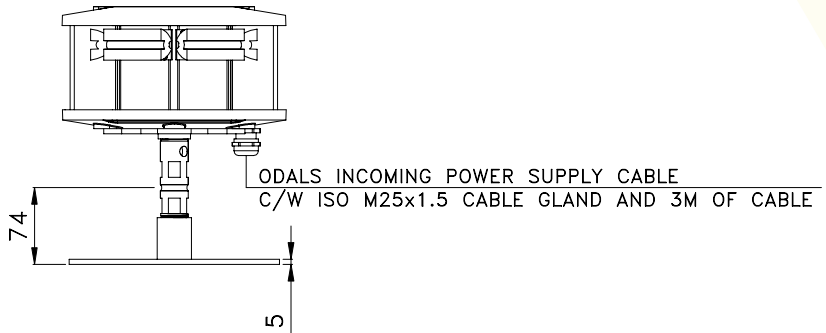

BEACON TOP VIEW

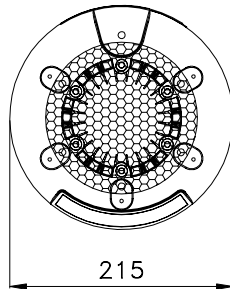

FIXING DETAILS

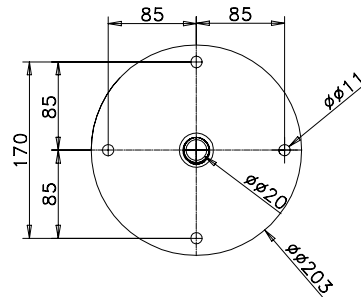

### PANEL DETAIL

TWILIGHT SENSOR



TO BE INSTALLED OUTSIDE  
LOOKING FREE SKY NORTH  
SUPPLIED AS LOOSE ITEM

FRONT VIEW

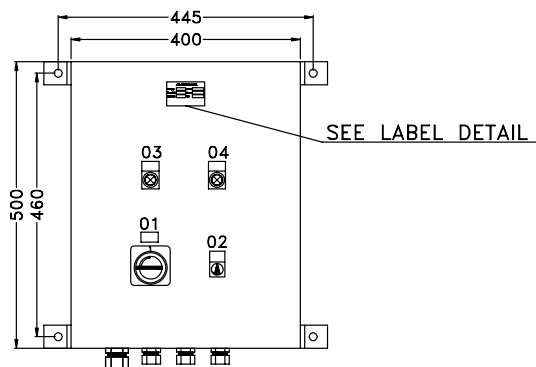

SIDE VIEW

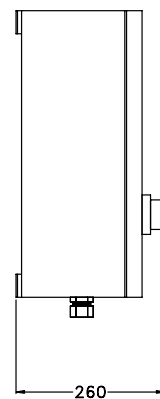

TWILIGHT SENSOR CABLE  
C/W CABLE GLAND ISO M20x1.5

LAND-1 POWER SUPPLY CABLE  
C/W CABLE GLAND ISO M20x1.5

INCOMING POWER SUPPLY CABLE  
C/W CABLE GLAND ISO M25x1.5

BOTTOM VIEW

ALARM SIGNALS CABLE  
C/W CABLE GLAND ISO M20x1.5

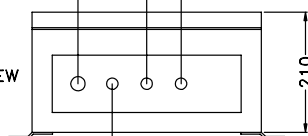

NOTE: typical drawing for control panel