

AERODROME BEACON



According to Annex 14 of ICAO regulations, Aeronautical Beacons should be provided at airports intended for use at night.

An Aerodrome Beacon shall be provided where the airport, due to the location or high background luminance, cannot be easily identified from the air by other identification means. The light displays white or white/green (for land airports) or white/yellow (for sea airports) flashing light with 20-30 flashes per minute.



ICAO AERONAUTICAL BEACONS

AERODROME BEACON

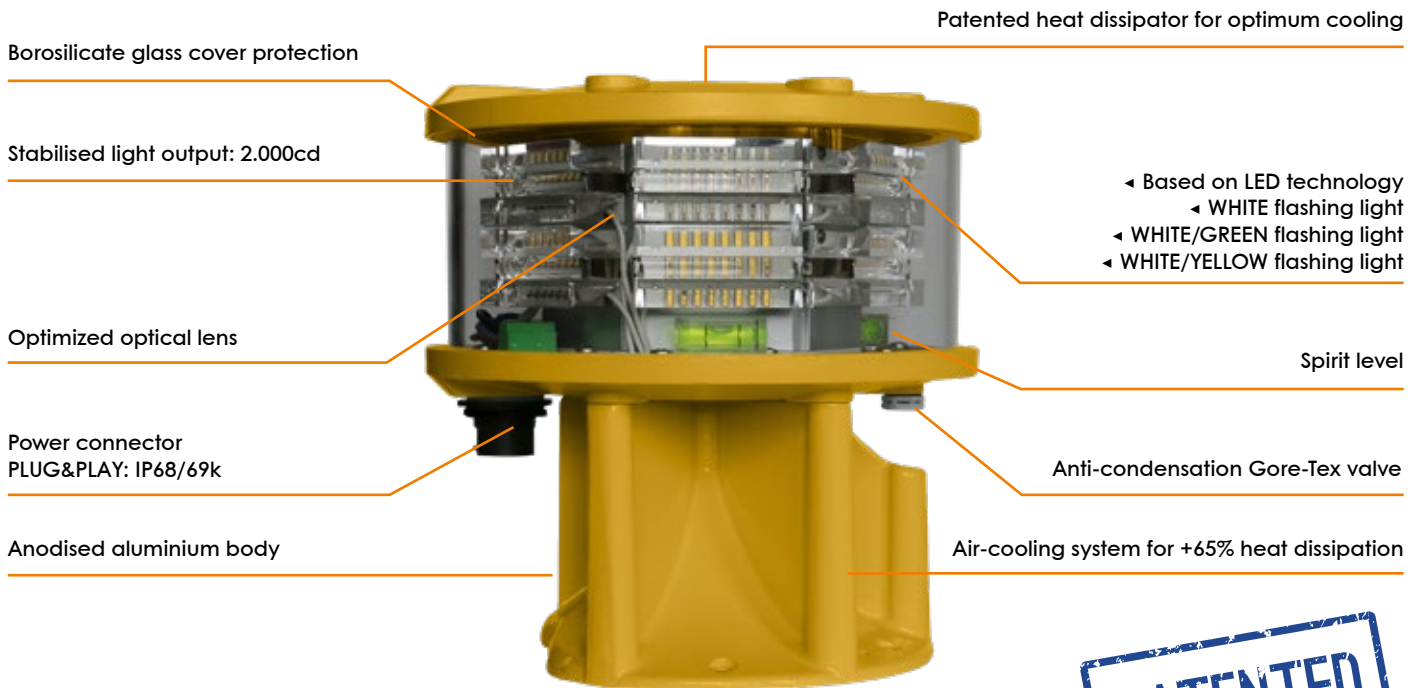

NOTE: electronic beacon driver in a separate enclosure

IP66



LUXSOLAR ADB-LXS Aeronautical Aerodrome Beacon is compliant to ICAO rule.

With a compact body, high quality and ultra-bright LEDs, customized lenses and patented shape for optimum light emission and beacon cooling LUXSOLAR ADB-LXS product is the most up-to-dated and technologically advanced Aeronautical Beacon.

This LED device is designed to not contain any electronic component (that is available in a separate control local panel): a huge advantage in terms of increased life-time and suitability to all environments (beacons can stand extreme weather conditions) and in terms of an easy maintenance (in case of maintenance or periodic checks on electronic components, these can be done at ground or easily accessible levels).

CERTIFICATION



COMPLIANCE



FEATURES

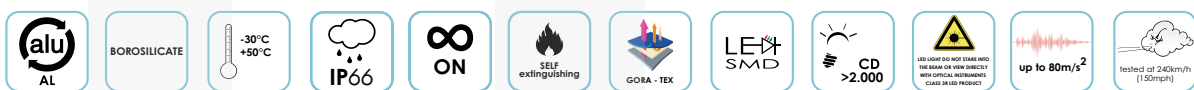

TYPICAL APPLICATION



ICAO AERONAUTICAL BEACONS

AERODROME BEACON TECHNICAL SPECIFICATIONS

OPTICAL FEATURES

- Based on LED technology
- WHITE light 2.000cd, night mode
- 20fpm to 30fpm
- Horizontal beam radiation 360°
- Vertical beam spread >1°
- PMMA lens
- Light output alignment device

MECHANICAL FEATURES

- Anodised aluminium body, painted yellow
- Borosilicate glass cover protection
- Silicon rubber, VMQ
- Base wind collector and internal heat sink for optimum cooling
- Degree of protection: IP66
- Anti-condensation Gore-Tex valve
- Operating temp.: -30°C to +50°C
- Lamp unit weight: 6kg

BOX MECHANICAL FEATURES

- Enclosure material: mild steel, painted RAL 7035
- Surge arrester
- Fault alarm
- Photocell (twilight sensor)
- Overvoltage protection

ELECTRICAL FEATURES

- Power supply by LUXSOLAR controller box
- Suitable for 24Vdc or 115/230Vac power supply
- LED feeded at constant current
- No RF - Radiations

OPTIONS

- Beacon support bracket
- GPS (Global Position System) syncro
- White/Yellow alternate flashes for water aerodromes (-SEA)
- White/Green alternate flashes for land aerodromes instead of white flashes only (-LAND)
- TWIN version: two separate LED circuits in the same fixture (normal + stand-by)

APPLY TO

- Airports intended for use at night and that can not be easily identified from the air by other means;
- Used to generally identify the presence of an aerodrome.

CERTIFICATIONS

- CE marking

COMPLIANCE

- ICAO Aerodromes -Annex 14 Volume 1, Par. 5.3.3 "Aeronautical Beacon"

PART NUMBER

- ADB-LXS-230VAC
- ADB-LXS-24VDC

PART NUMBER FOR OPTIONAL VERSIONS

- ADB-LXS-T-230VAC
- ADB-LXS-T-24VDC
- ADB-LXS-T-230VAC-LAND
- ADB-LXS-T-24VDC-LAND
- ADB-LXS-T-230VAC-SEA
- ADB-LXS-T-24VDC-SEA

ICAO AERONAUTICAL BEACONS

AERODROME BEACON TECHNICAL DRAWING

VALID FOR ADB

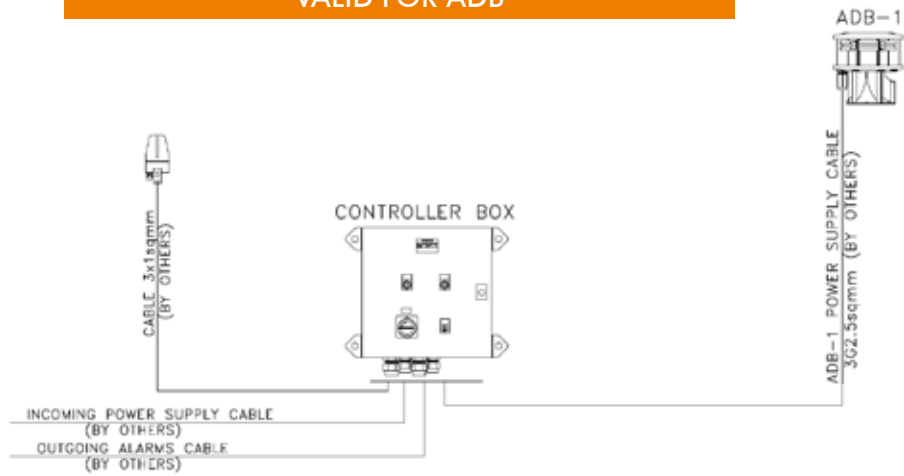

VALID FOR ADB-TWIN AND ADB-LAND

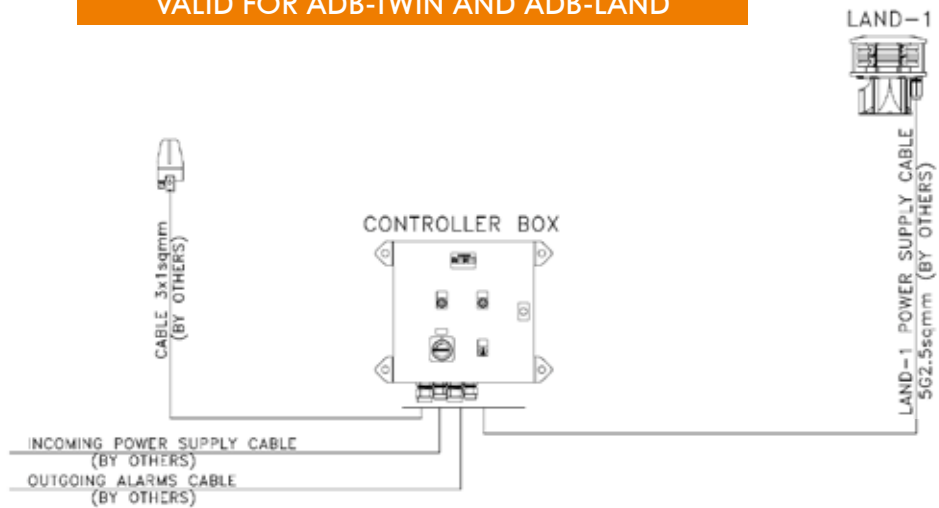

VALID FOR ADB-LAND-TWIN

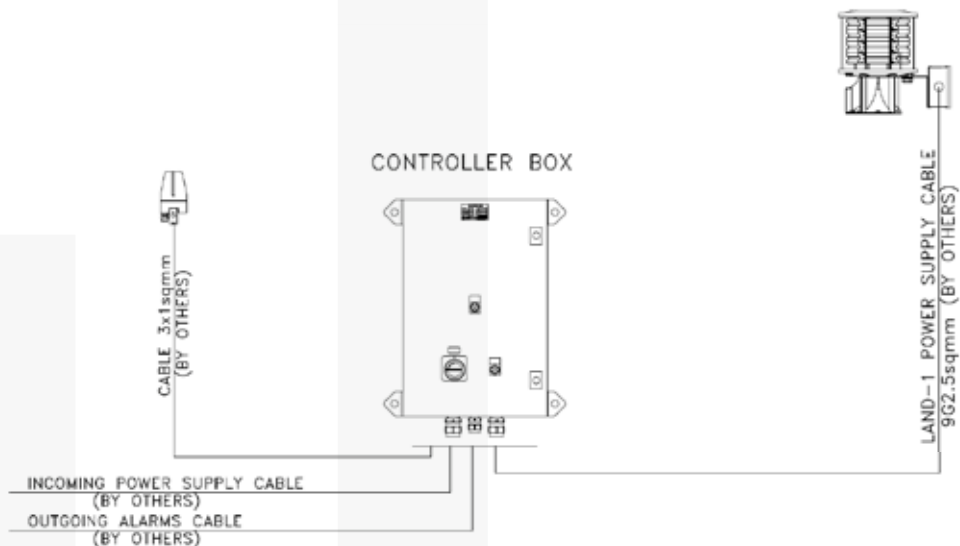

NOTE: Drawing referred to land aerodrome beacon

ICAO AERONAUTICAL BEACONS

AERODROME BEACON TECHNICAL SPECIFICATIONS

BEACON DETAIL

VALID FOR ADB / ADB-LAND / ADB-TWIN

BEACON FRONT VIEW

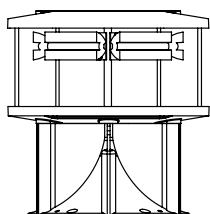

BEACON SIDE VIEW

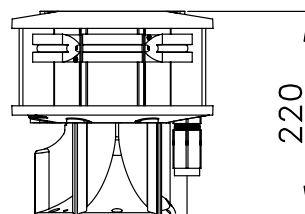

INCOMING POWER SUPPLY CABLE
C/W CONNECTOR (CABLE O.D. 7/14mm, Max size 2.5sqmm)

BEACON TOP VIEW

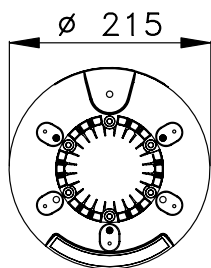

FIXING DETAILS

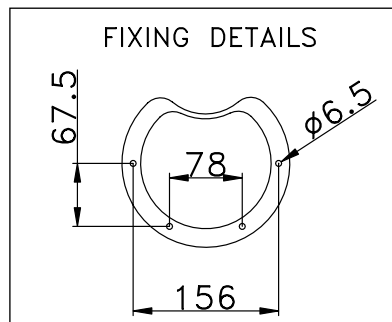

VALID FOR ADB-LAND-TWIN

RIGHT SIDE VIEW

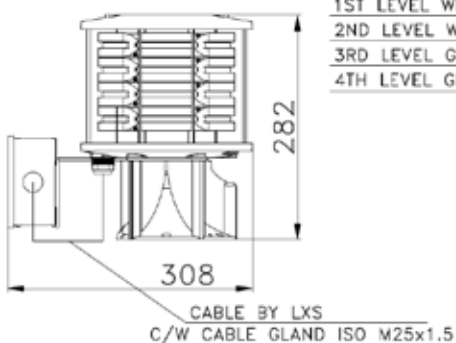

BEACON FRONT VIEW

1ST LEVEL WHITE NORMAL
2ND LEVEL WHITE EMERGENCY
3RD LEVEL GREEN NORMAL
4TH LEVEL GREEN EMERGENCY

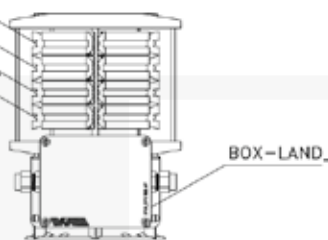

LEFT SIDE VIEW

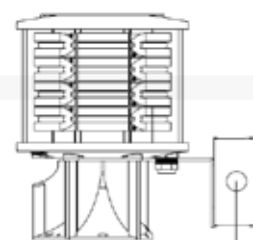

L801A POWER SUPPLY CABLE
C/W CABLE GLAND ISO M25x1.5

TOP VIEW

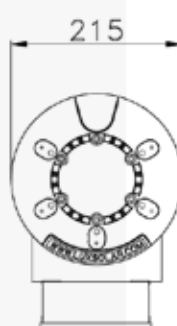

FIXING DETAILS

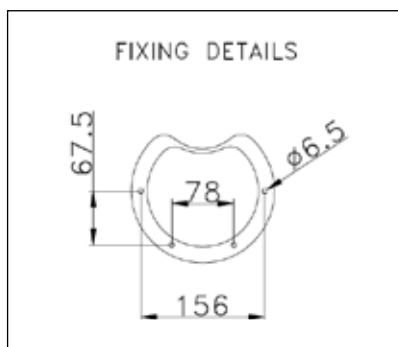

ICAO AERONAUTICAL BEACONS

AERODROME BEACON TECHNICAL DRAWING

PANEL DETAIL

VALID FOR ADB / ADB-LAND / ADB-TWIN

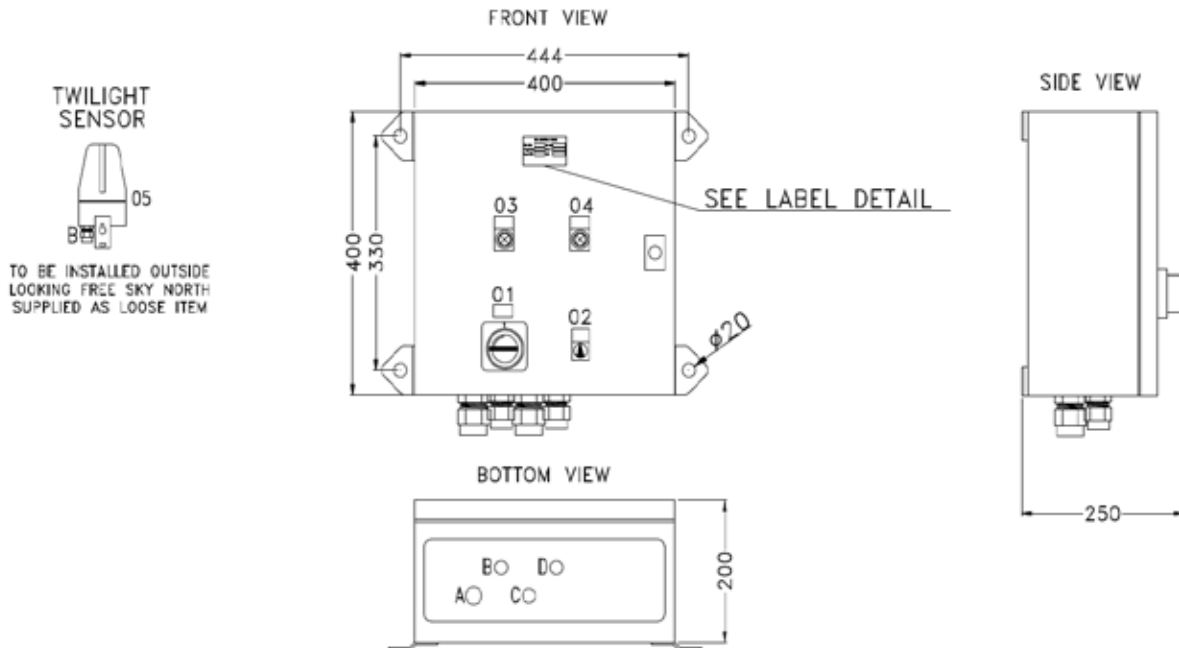

VALID FOR ADB-LAND-TWIN

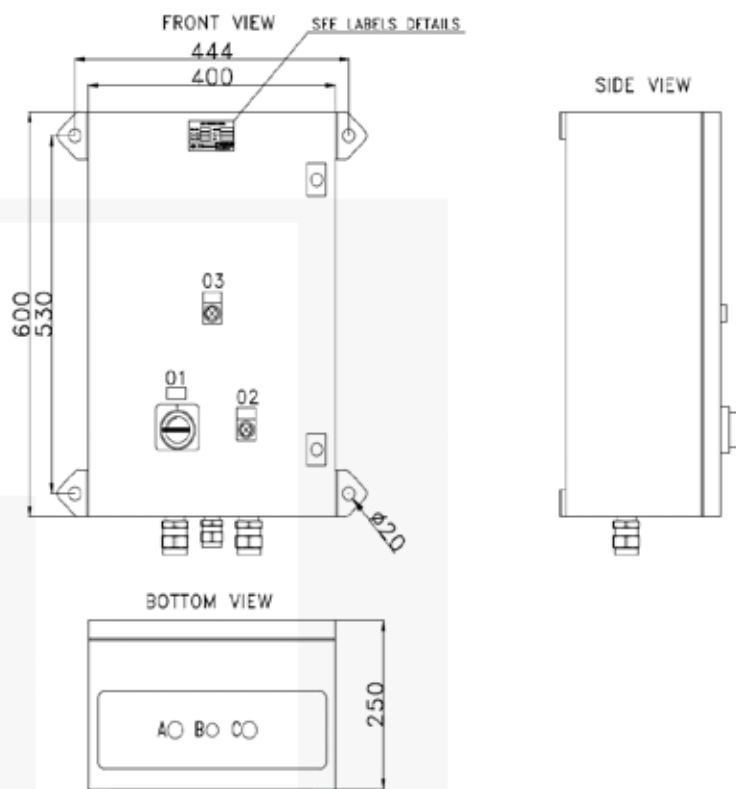

NOTE: Drawing referred to land aerodrome beacon