



# LUXSOLAR® CATALOGUE

## Airfield Beacons

rev\_250205\_A



[www.luxsolar.com](http://www.luxsolar.com)

Luxsolar® is a department  
of CE2K S.r.l.



*Luxsolar and LXS - registered trademarks of CEZK S.r.l. - identify a series of special lighting suitable both for potentially explosive atmospheres and safe areas.*

*Today, after a decade marked by a growing global market presence, Luxsolar has become the first manufacturer of LED Aircraft Warning Lights offering a complete range from low to high intensity.*

*All LUXSOLAR products, designed and manufactured in Italy, are the result of a constant R&D activity performed in-house.*

*Luxsolar mission is to create innovative products that combine high-tech and sustainable features. Our aim is to offer tailor-made lighting solutions in compliance to local and international regulations for airports, heliports, marine environments and elevated structures.*

A handwritten signature in black ink, appearing to read 'N. Volpe', is positioned above the LUXSOLAR logo and tagline.

**LUXSOLAR**

*#everything is made for passion*

## INDEX

### AERONAUTICAL BEACONS - ICAO

Product Line for ICAO .....	5
Follow me for vehicles.....	6
Identification Beacon.....	10
Aerodrome Beacon.....	16
Circling Guidance Light.....	22
Airport Windsock Collapsible version .....	26

### AERONAUTICAL BEACONS - FAA

Product Line for FAA .....	31
Omni- Directional Approach lighting System (ODALS).....	32
Runway end Identification lights (REIL) .....	36
Airport Beacon L801A-LXS .....	40
Airport Beacon L802A-LXS .....	46
Seaplane Beacon L801S-LXS.....	50

### CONTACTS

C&E S.r.l.....	59
----------------	----





# AERONAUTICAL BEACONS

## PRODUCT LINE TYPICAL INSTALLATION SURFACE LEVEL AERONAUTICAL ICAO CONFIGURATION



CIRCLING GUIDANCE LIGHT



FOLLOW ME VEHICLES



IDENTIFICATION BEACON



AERODROME BEACON



### LEGEND



AERODROME BEACON



CIRCLING GUIDANCE LIGHT



IDENTIFICATION BEACON



FOLLOW ME VEHICLES

Image is for informational purposes only.

# VEHICLE LIGHTS

## LIOL-C / LIOL-D



As specified by ICAO Annex 14 regulation, Low Intensity Obstruction Light Type C / Type D should be used on vehicles operating on airfield area.



# VEHICLE LIGHTS

## LIOL-C / LIOL-D



With low-weight and increased heat dissipation this LED device is the ideal solution for an efficient and compact signalling, able to guarantee a product life exceeding ten years, along with a reduced power consumption.

LIOL Type C / Type D light emits omnidirectional amber flashing light while vehicle is moving; then the light can be switched to red steady burning (LIOL Type B) when vehicle is not conducting operations and constitutes an hazard on airfield ground.

### CERTIFICATION



### COMPLIANCE



### FEATURES



### TYPICAL APPLICATION



# VEHICLE LIGHTS

## LIOL-C / LIOL-D TECHNICAL SPECIFICATIONS

### OPTICAL FEATURES

- Based on LED technology
- RED light - steady burning (Type B)
- AMBER light flashing 60-90fpm (Type D)
- 32cd RED Type B
- 40cd AMBER Type C
- 200cd AMBER Type D
- Horizontal beam radiation 360°
- Optical reflector

### MECHANICAL FEATURES

- Anodised aluminium body with magnetic base
- Polycarbonate UV resistant dome
- Polyurethane foam
- Degree of protection: IP66
- Operating temperature: -20°C to +50°C
- Lamp unit weight: 1kg approx

### ELECTRICAL FEATURES

- Nominal operating voltage 12/24VDC
- LED feeded at constant current

### APPLY TO

- Airfield ground support vehicles

### CERTIFICATIONS

- CE marking
- ICAO Aerodromes -Annex 14 Volume 1, Type B, Type C and Type D

### ORDER CODE - TYPE D

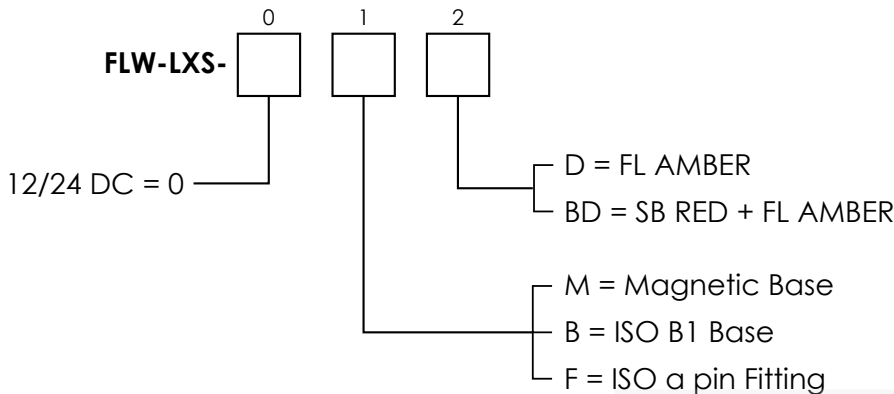

### ORDER CODE - TYPE C

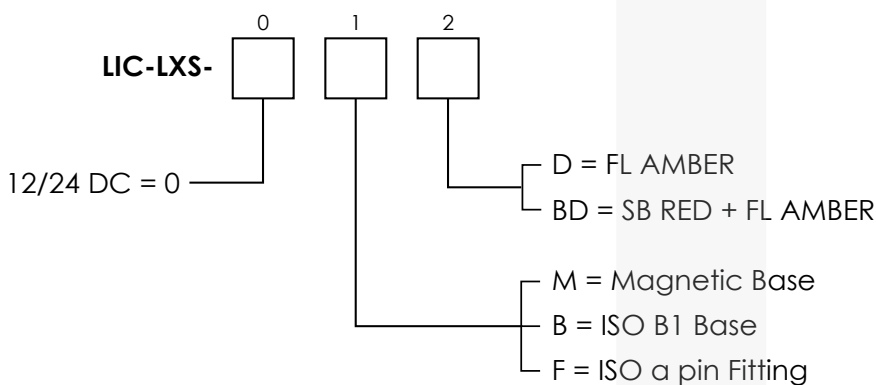



# VEHICLE LIGHTS

## LIOL-C / LIOL-D TECHNICAL DRAWING

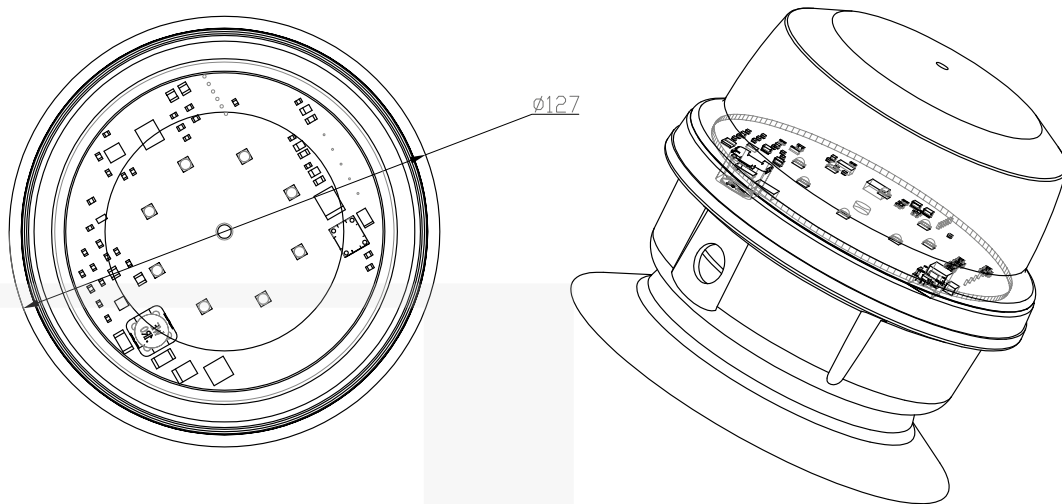
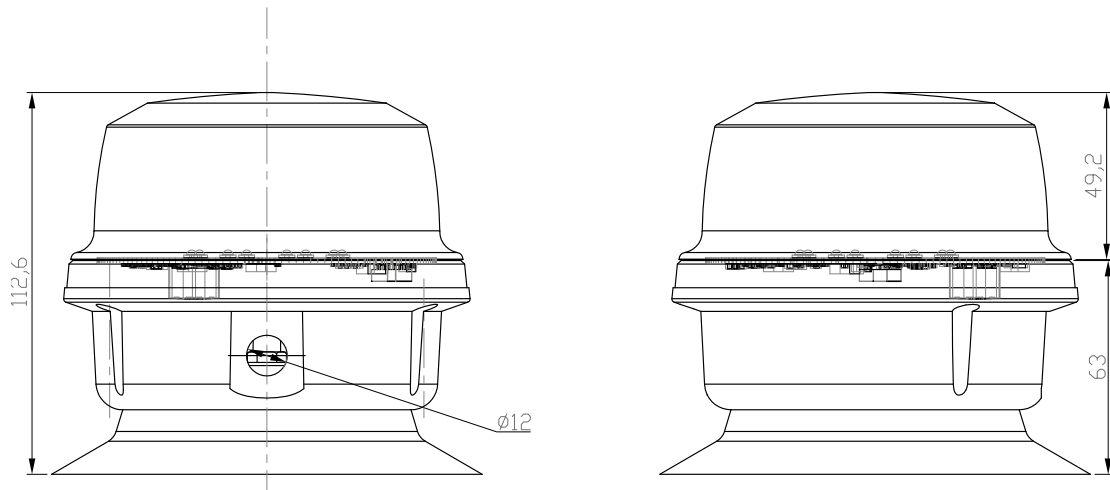

## IDENTIFICATION BEACON



According to Annex 14 of ICAO regulations, Aeronautical Beacons should be provided at airports intended for use at night.

An Identification Beacon shall be provided where the airport, due to the location or high background luminance, cannot be easily identified from the air by other identification means. The light displays a green or yellow flashing light in the International Morse Code that identifies the airport, and ICAO or IATA Airport Letters can be used.



# ICAO AERONAUTICAL BEACONS

## IDENTIFICATION BEACON

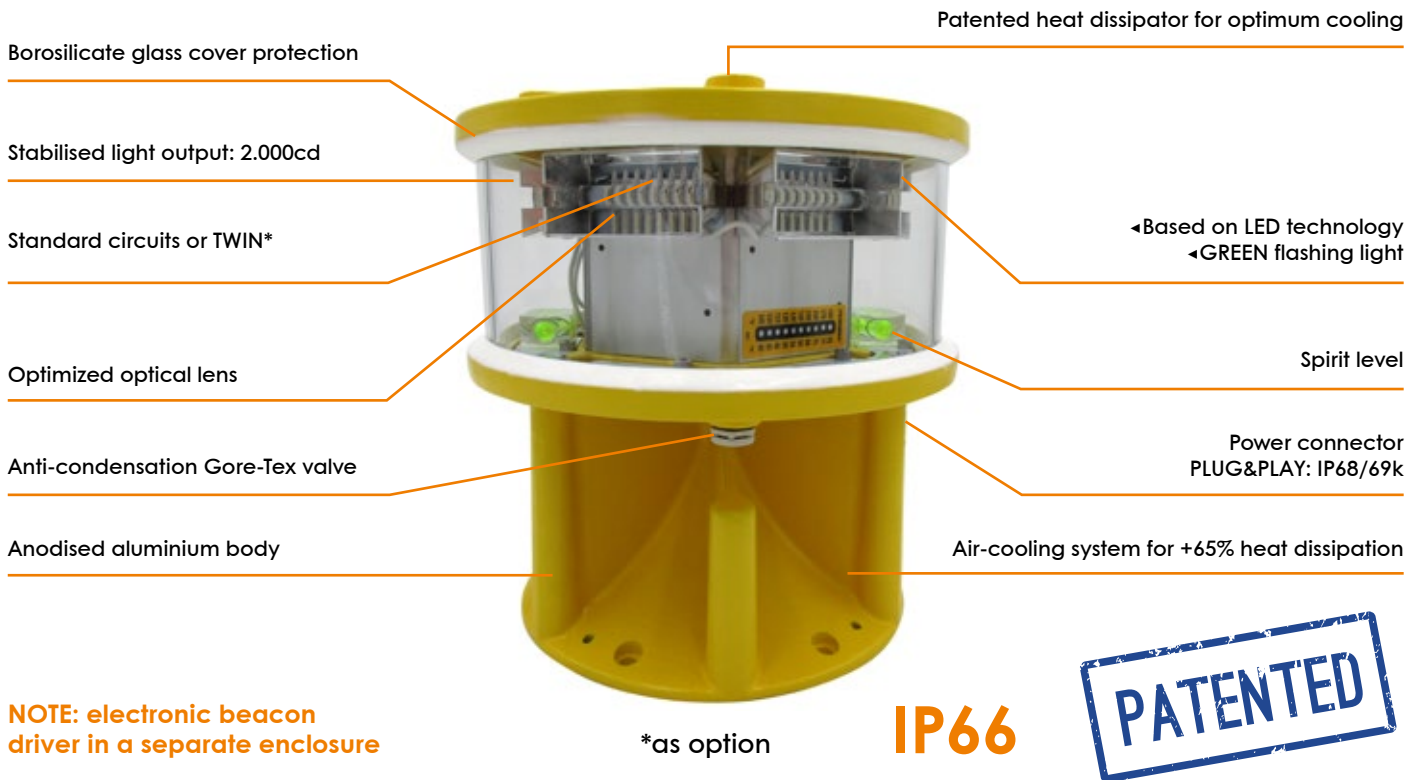

LUXSOLAR IDB-LXS Aeronautical Identification Beacon is compliant and tested as fully compliant to ICAO rule.

With a compact body, high quality and ultra-bright LEDs, customized lenses and patented shape for optimum light emission and beacon cooling LUXSOLAR IDB-LXS product is the most up-to-dated and technologically advanced Aeronautical Beacon.

This LED device is designed to not contain any electronic component (that is available in a separate control local panel): a huge advantage in terms of increased life-time and suitability to all environments (beacons can stand extreme weather conditions) and in terms of an easy maintenance (in case of maintenance or periodic checks on electronic components, these can be done at ground or easily accessible levels).

### CERTIFICATION



### COMPLIANCE



### FEATURES



### TYPICAL APPLICATION



# ICAO AERONAUTICAL BEACONS

## IDENTIFICATION BEACON TECHNICAL SPECIFICATIONS

### OPTICAL FEATURES

- Based on LED technology
- GREEN light 2.000cd, night mode
- Airport IATA/ICAO Morse Code Flash
- Horizontal beam radiation 360°
- Vertical beam spread >1°
- PMMA lens
- Light output alignment device

### LIGHT MECHANICAL FEATURES

- Anodised aluminium body, painted yellow
- Borosilicate glass cover protection
- Silicon rubber, VMQ
- Base wind collector and internal heat sink for optimum cooling
- Degree of protection: IP66
- Anti-condensation Gore-Tex valve
- Operating temp.: -30°C to +50°C
- Lamp unit weight: 6kg

### BOX MECHANICAL FEATURES

- Enclosure material: mild steel, painted RAL 7035
- Surge arrester
- Fault alarm
- Photocell (twilight sensor)
- Overvoltage protection

### ELECTRICAL FEATURES

- Power supply by LUXSOLAR controller box
- Suitable for 24Vdc or 115/230Vac power supply
- LED feeded at constant current
- No RF - Radiations

### OPTIONS

- Beacon support bracket
- GPS (Global Position System) syncro
- Yellow flashing light for water aerodromes
- TWIN version: two separate LED circuits in the same fixture (normal + stand-by)

### APPLY TO

- Airports intended for use at night and that can not be easily identified from the air by other means;
- Used to specifically identify the presence of an aerodrome.

### CERTIFICATIONS

- ICAO test report (EN 17025 Laboratory) NR. 466-QL19-R02
- CE marking

### COMPLIANCE

- ICAO Aerodromes -Annex 14 Volume 1, Par. 5.3.3 "Aeronautical Beacon"

### PART NUMBER

- IDB-LXS-IATA-AIRPORT CODE\* 230VAC
- IDB-LXS-IATA-AIRPORT CODE\*\* 24VDC
- IDB-LXS-ICAO-AIRPORT CODE\*<sup>1</sup> 230VAC
- IDB-LXS-ICAO-AIRPORT CODE\*\*<sup>1</sup> 24VDC

- \* Example: Identification beacon for Amsterdam Airport, part number will be: IDB-LXS-IATA-AMS-230VAC
- \*\* Example: Identification beacon for John F. Kennedy Intl., part number will be: IDB-LXS-IATA-JFK-24VDC
- \*<sup>1</sup> Example: Identification beacon for Malpensa Airport, part number will be: IDB-LXS-ICAO-LIMC-230VAC
- \*\*<sup>1</sup> Example: Identification beacon for Madrid Barajas Airport, part number will be: IDB-LXS-ICAO-LEMD-24VDC

# ICAO AERONAUTICAL BEACONS

## IDENTIFICATION BEACON TECHNICAL DRAWING

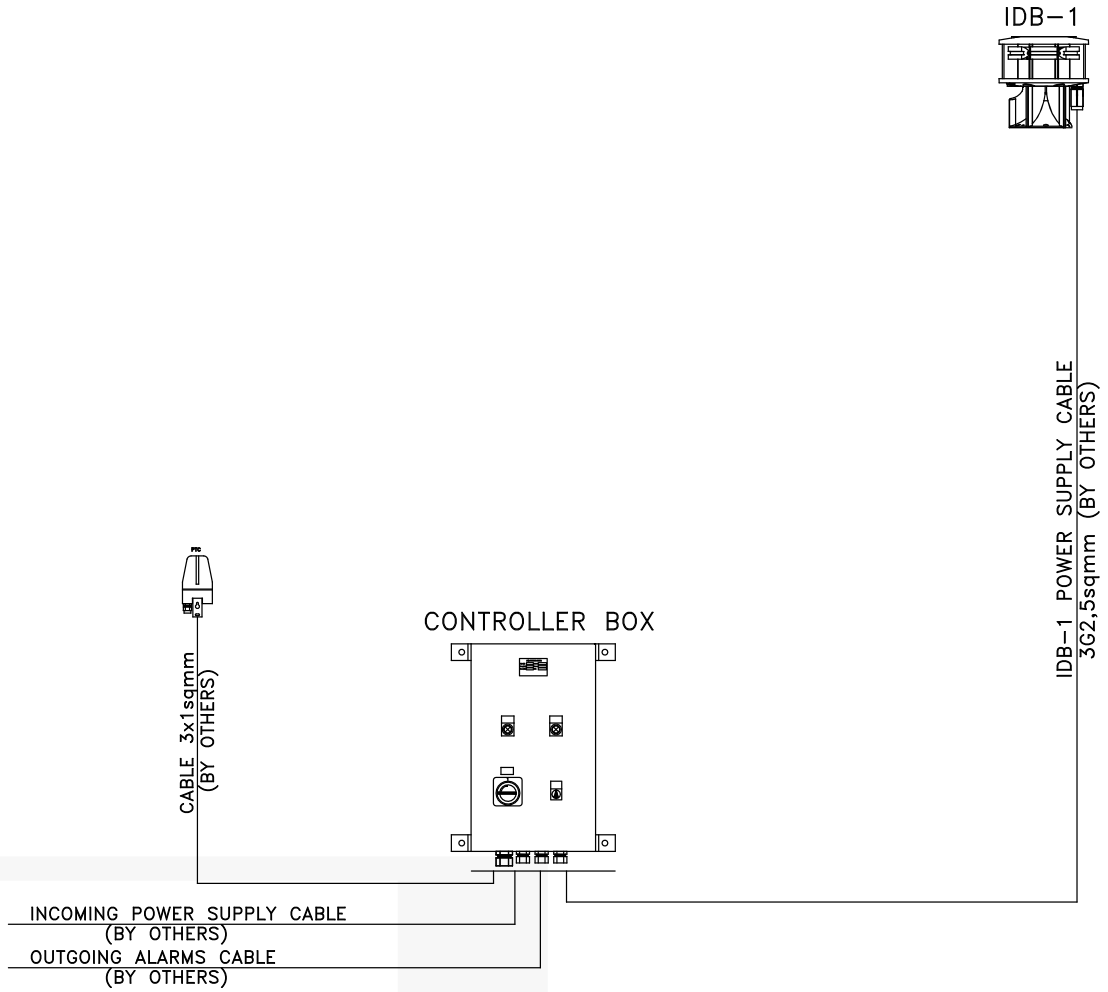

# ICAO AERONAUTICAL BEACONS

## IDENTIFICATION BEACON TECHNICAL DRAWING

### BEACON DETAIL

BEACON FRONT VIEW

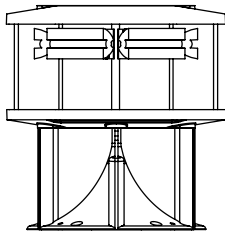

BEACON SIDE VIEW

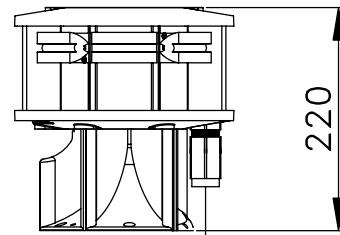

INCOMING POWER SUPPLY CABLE  
C/W CONNECTOR (CABLE O.D. 7/14mm, Max size 2.5sqmm)

BEACON TOP VIEW

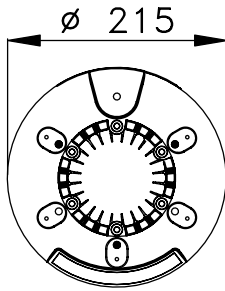

FIXING DETAILS

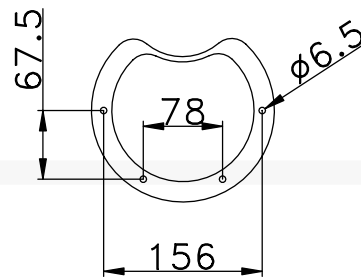

# ICAO AERONAUTICAL BEACONS

## IDENTIFICATION BEACON TECHNICAL DRAWING

### PANEL DETAIL

TWILIGHT  
SENSOR  
05

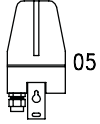

TO BE INSTALLED OUTSIDE  
LOOKING FREE SKY NORTH  
SUPPLIED AS LOOSE ITEM

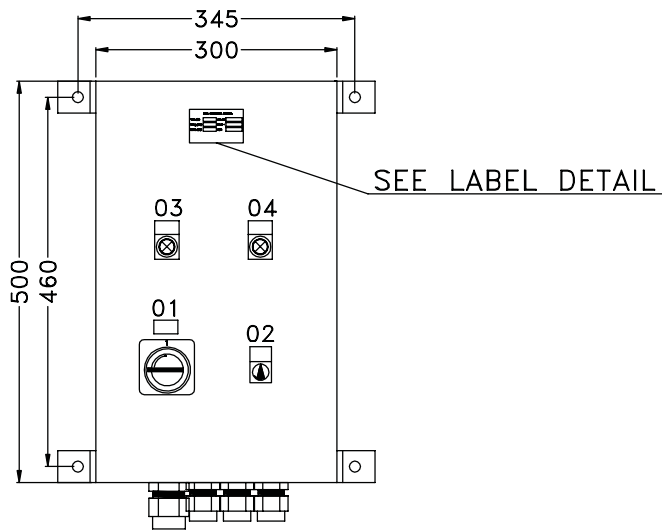

SIDE VIEW

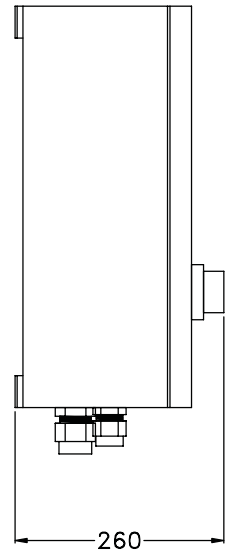

BOTTOM VIEW

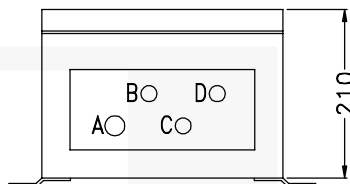

## AERODROME BEACON



According to Annex 14 of ICAO regulations, Aeronautical Beacons should be provided at airports intended for use at night.

An Aerodrome Beacon shall be provided where the airport, due to the location or high background luminance, cannot be easily identified from the air by other identification means. The light displays white or white/green (for land airports) or white/yellow (for sea airports) flashing light with 20-30 flashes per minute.





# ICAO AERONAUTICAL BEACONS

## AERODROME BEACON

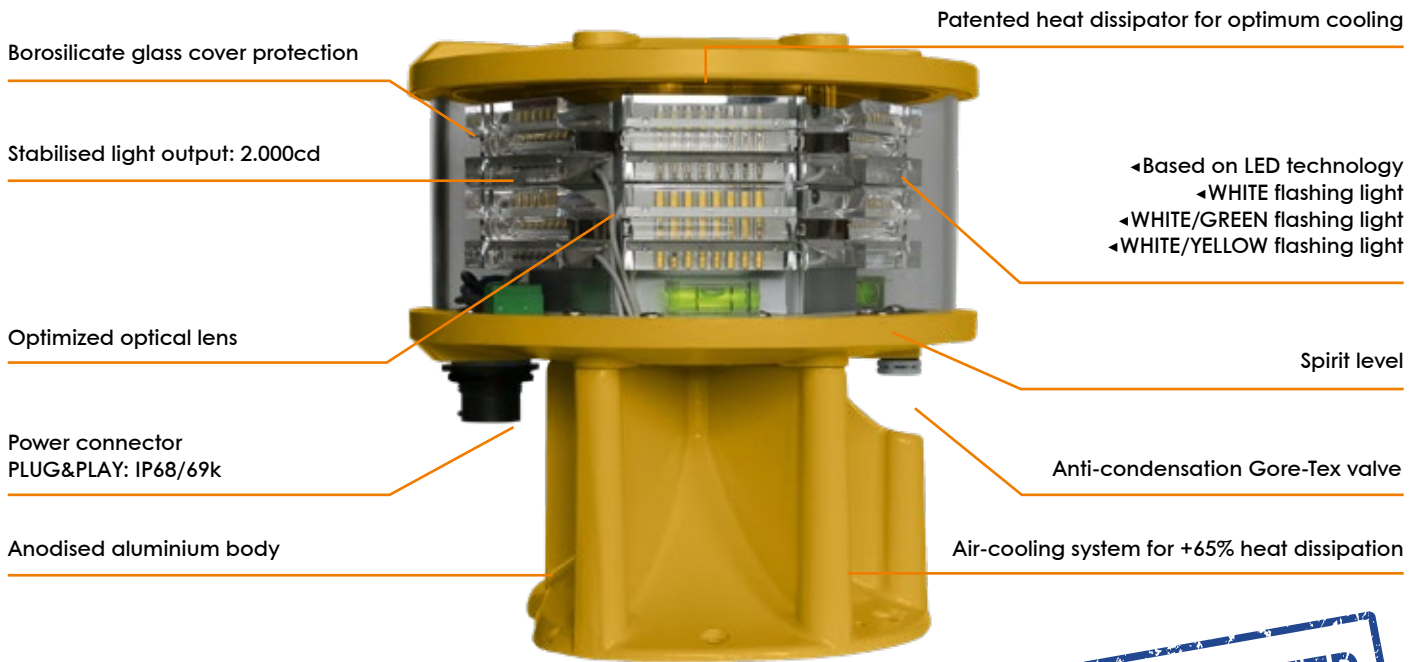

**NOTE: electronic beacon driver in a separate enclosure**

**IP66**



LUXSOLAR ADB-LXS Aeronautical Aerodrome Beacon is compliant to ICAO rule.

With a compact body, high quality and ultra-bright LEDs, customized lenses and patented shape for optimum light emission and beacon cooling LUXSOLAR ADB-LXS product is the most up-to-dated and technologically advanced Aeronautical Beacon.

This LED device is designed to not contain any electronic component (that is available in a separate control local panel): a huge advantage in terms of increased life-time and suitability to all environments (beacons can stand extreme weather conditions) and in terms of an easy maintenance (in case of maintenance or periodic checks on electronic components, these can be done at ground or easily accessible levels).

### CERTIFICATION



### COMPLIANCE



### FEATURES



### TYPICAL APPLICATION



# ICAO AERONAUTICAL BEACONS

## AERODROME BEACON TECHNICAL SPECIFICATIONS

### OPTICAL FEATURES

- Based on LED technology
- WHITE light 2.000cd, night mode
- 20fpm to 30fpm
- Horizontal beam radiation 360°
- Vertical beam spread >1°
- PMMA lens
- Light output alignment device

### MECHANICAL FEATURES

- Anodised aluminium body, painted yellow
- Borosilicate glass cover protection
- Silicon rubber, VMQ
- Base wind collector and internal heat sink for optimum cooling
- Degree of protection: IP66
- Anti-condensation Gore-Tex valve
- Operating temp.: -30°C to +50°C
- Lamp unit weight: 6kg

### BOX MECHANICAL FEATURES

- Enclosure material: mild steel, painted RAL 7035
- Surge arrester
- Fault alarm
- Photocell (twilight sensor)
- Overvoltage protection

### ELECTRICAL FEATURES

- Power supply by LUXSOLAR controller box
- Suitable for 24Vdc or 115/230Vac power supply
- LED feeded at constant current
- No RF - Radiations

### OPTIONS

- Beacon support bracket
- GPS (Global Position System) syncro
- White/Yellow alternate flashes for water aerodromes (-SEA)
- White/Green alternate flashes for land aerodromes instead of white flashes only (-LAND)
- TWIN version: two separate LED circuits in the same fixture (normal + stand-by)

### APPLY TO

- Airports intended for use at night and that can not be easily identified from the air by other means;
- Used to generally identify the presence of an aerodrome.

### CERTIFICATIONS

- CE marking

### COMPLIANCE

- ICAO Aerodromes -Annex 14 Volume 1, Par. 5.3.3 "Aeronautical Beacon"

### PART NUMBER

- ADB-LXS-230VAC
- ADB-LXS-24VDC

### PART NUMBER FOR OPTIONAL VERSIONS

- ADB-LXS-T-230VAC
- ADB-LXS-T-24VDC
- ADB-LXS-T-230VAC-LAND
- ADB-LXS-T-24VDC-LAND
- ADB-LXS-T-230VAC-SEA
- ADB-LXS-T-24VDC-SEA

# ICAO AERONAUTICAL BEACONS

## AERODROME BEACON TECHNICAL DRAWING

VALID FOR ADB

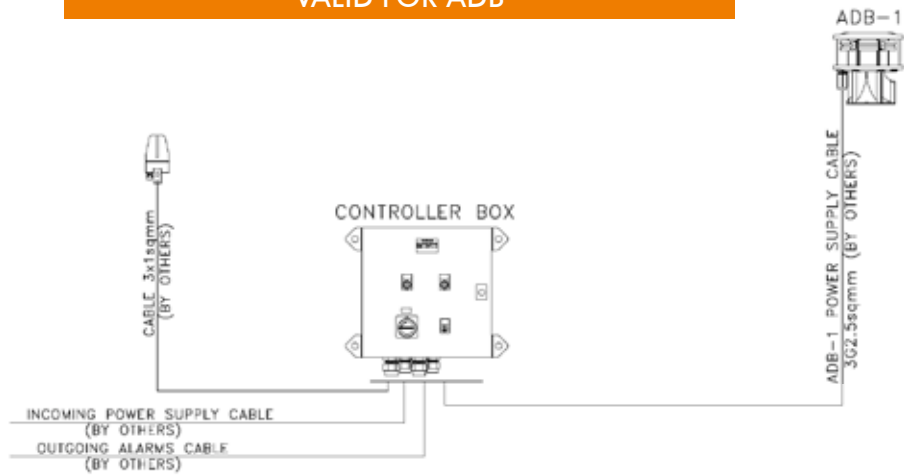

VALID FOR ADB-TWIN AND ADB-LAND

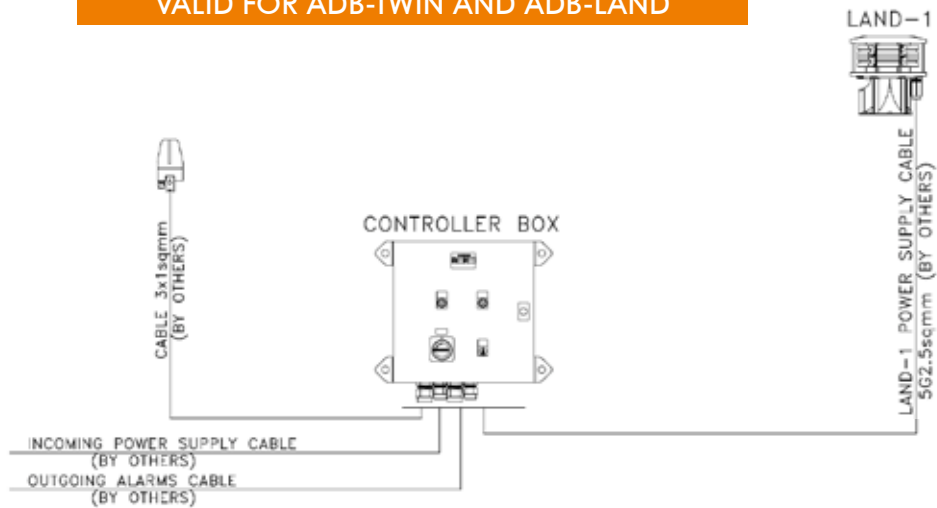

VALID FOR ADB-LAND-TWIN

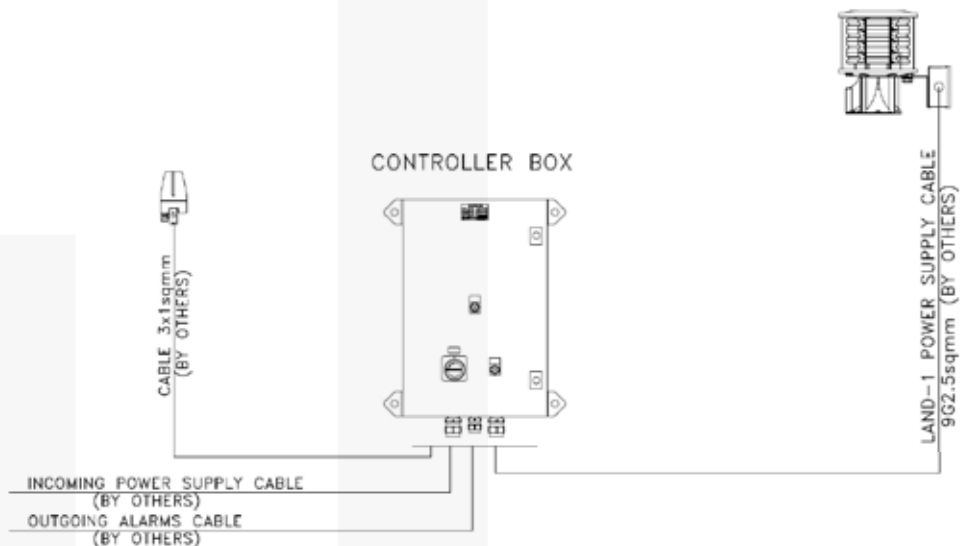

NOTE: Drawing referred to land aerodrome beacon

# ICAO AERONAUTICAL BEACONS

## AERODROME BEACON TECHNICAL SPECIFICATIONS

### BEACON DETAIL

VALID FOR ADB / ADB-LAND / ADB-TWIN

BEACON FRONT VIEW

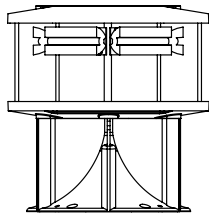

BEACON SIDE VIEW

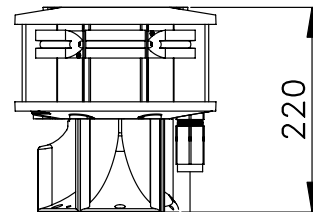

INCOMING POWER SUPPLY CABLE  
C/W CONNECTOR (CABLE O.D. 7/14mm, Max size 2.5sqmm)

BEACON TOP VIEW

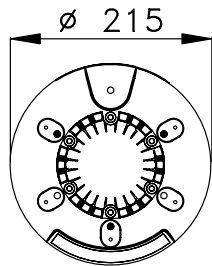

FIXING DETAILS

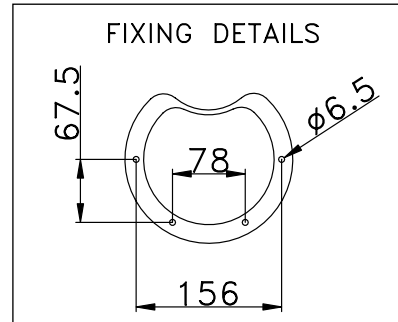

VALID FOR ADB-LAND-TWIN

RIGHT SIDE VIEW

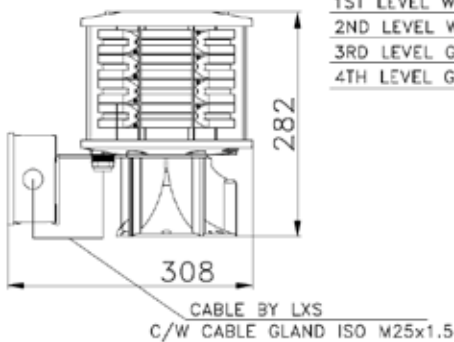

BEACON FRONT VIEW

1ST LEVEL WHITE NORMAL  
2ND LEVEL WHITE EMERGENCY  
3RD LEVEL GREEN NORMAL  
4TH LEVEL GREEN EMERGENCY

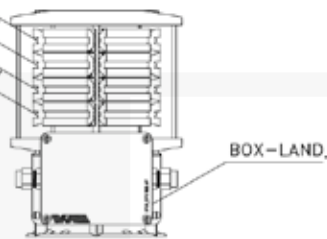

LEFT SIDE VIEW

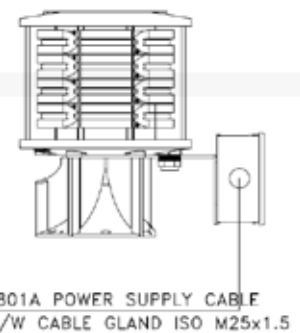

TOP VIEW



FIXING DETAILS

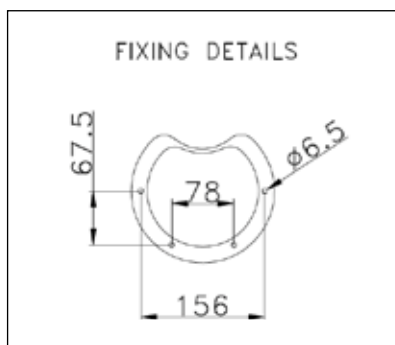

# ICAO AERONAUTICAL BEACONS

## AERODROME BEACON TECHNICAL DRAWING

### PANEL DETAIL

VALID FOR ADB / ADB-LAND / ADB-TWIN

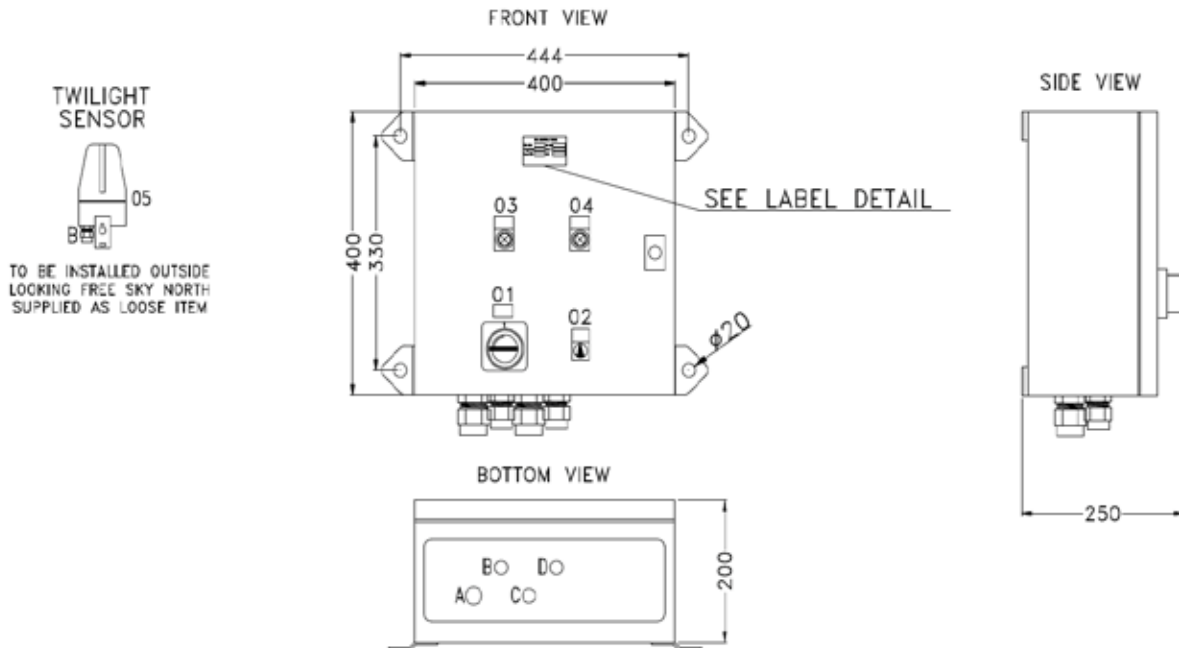

VALID FOR ADB-LAND-TWIN

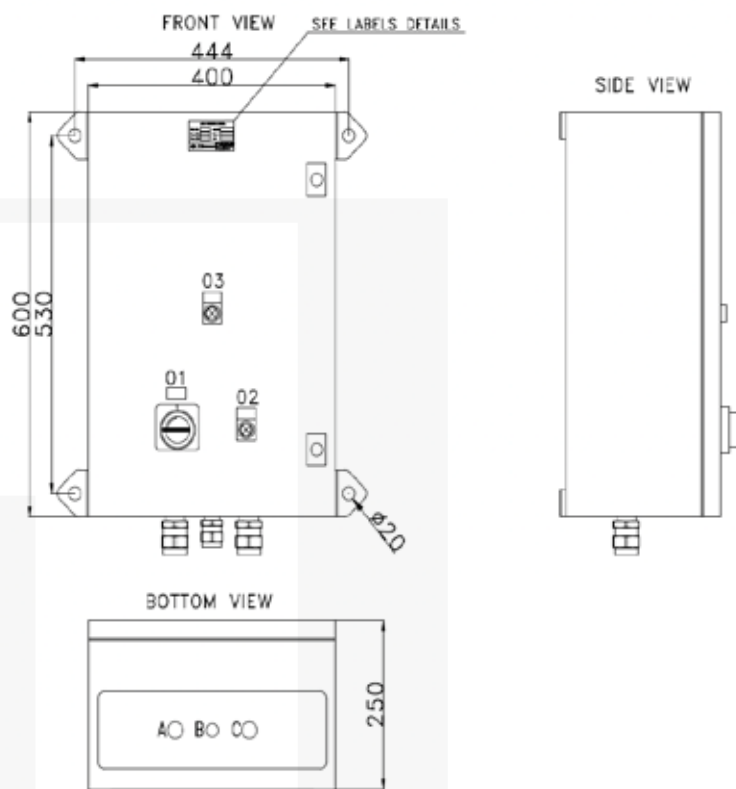

NOTE: Drawing referred to land aerodrome beacon

## CIRCLING GUIDANCE LIGHT



According to Annex 14 of ICAO regulations, Circling Guidance Lights should be provided at airports if the existing approach or runway lighting does not allow easy identification of the runway. The light displays white flashing light.



# ICAO AERONAUTICAL BEACONS

## CIRCLING GUIDANCE LIGHT

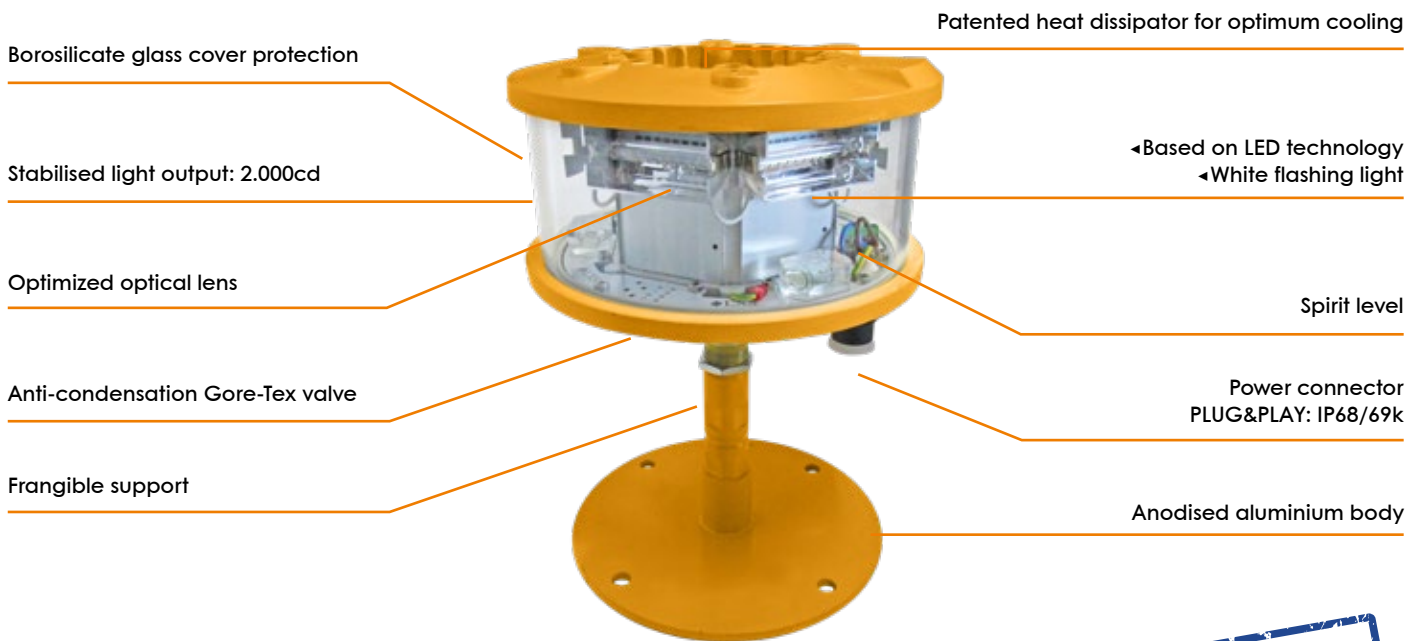

**NOTE: electronic beacon driver in a separate enclosure**

**IP66**



LUXSOLAR CGL-LXS Circling Guidance Light is compliant to ICAO rule.

With a compact body, high quality and ultra-bright LEDs, customized lenses and patented shape for optimum light emission and beacon cooling LUXSOLAR CGL-LXS product is the most up-to-dated and technologically advanced Aeronautical Beacon.

This LED device is designed to not contain any electronic component (that is available in a separate control local panel): a huge advantage in terms of increased life-time and suitability to all environments (beacons can stand extreme weather conditions) and in terms of an easy maintenance (in case of maintenance or periodic checks on electronic components, these can be done at ground or easily accessible levels).

### CERTIFICATION



### COMPLIANCE



### FEATURES



### TYPICAL APPLICATION



# ICAO AERONAUTICAL BEACONS

## CIRCLING GUIDANCE LIGHT TECHNICAL SPECIFICATIONS

### OPTICAL FEATURES

- Based on LED technology
- 5.000cd day mode, WHITE flashing \*
- 1.500cd twilight mode, WHITE flashing \*
- 600cd night mode, WHITE flashing \*
- Horizontal beam radiation 360°
- Vertical beam spread from 2° to 10°
- PMMA lens
- Light output alignment device

### MECHANICAL FEATURES

- Anodised aluminium body, painted yellow
- Borosilicate glass cover protection
- Silicon rubber, VMQ
- Base wind collector and internal heat sink for optimum cooling
- Frangible support
- Degree of protection: IP66
- Operating temperature: -30°C +50°C
- Lamp unit weight: 8kg

### BOX MECHANICAL FEATURES

- Enclosure material: mild steel, painted RAL 7035
- Surge arrester
- Fault alarm
- Photocell (twilight sensor)
- Overvoltage protection

### ELECTRICAL FEATURES

- Suitable for 24Vdc or 115/230Vac power supply by LUXSOLARcontroller box
- LED feeded at constant current
- No RF-radiations

### APPLY TO

- Precision approach runway intended for use by day or night when existing approach lighting systems do not satisfactorily permit identification of the runway.

### CERTIFICATIONS

- CE marking

### COMPLIANCE

- ICAO Aerodromes -Annex 14 Volume 1, Chapter 5
- ICAO Aerodrome Design Manual doc. 9157, part 4 Visual Aids, Chapter 7

### PART NUMBER

- CGL-LXS-8

### CIRCLING GUIDANCE LIGHT

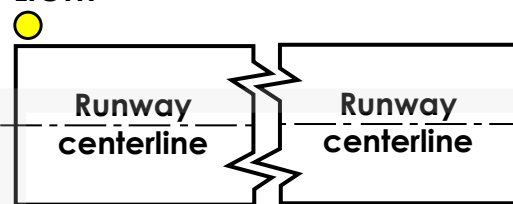

### CIRCLING GUIDANCE LIGHT

\* for visibility 1.500m to 5.000m



# ICAO AERONAUTICAL BEACONS

## CIRCLING GUIDANCE LIGHT TECHNICAL DRAWING

### BEACON DETAIL

BEACON SIDE VIEW

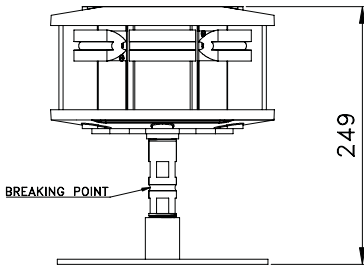

BEACON FRONT VIEW

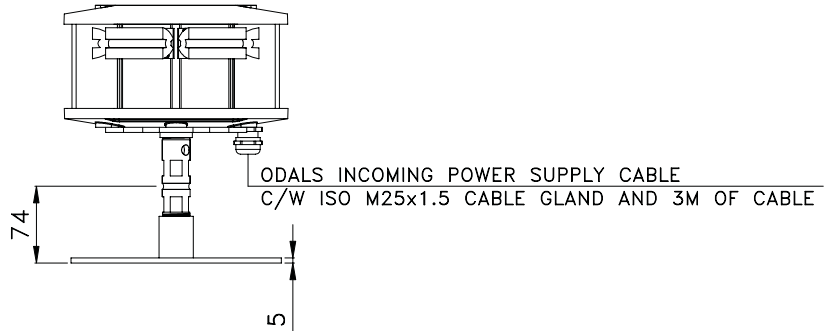

BEACON TOP VIEW

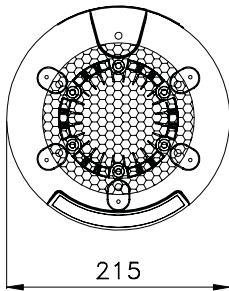

FIXING DETAILS

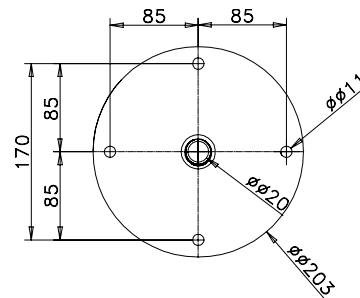

### PANEL DETAIL

FRONT VIEW

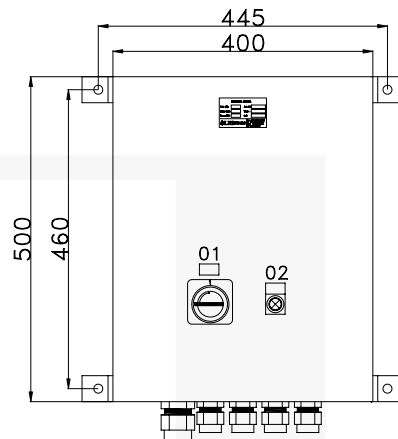

SIDE VIEW

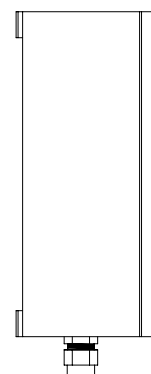

REMOTE COMMAND SIGNALS CABLE  
C/W CABLE GLAND ISO M25x1.5  
ALARMS SIGNALS CABLE  
C/W CABLE GLAND ISO M25x1.5  
INCOMING POWER SUPPLY CABLE  
C/W CABLE GLAND ISO M32x1.5

REIL-1 BEACON POWER SUPPLY CABLE  
C/W CABLE GLAND ISO M25x1.5  
REIL-2 BEACON POWER SUPPLY CABLE  
C/W CABLE GLAND ISO M25x1.5

BOTTOM VIEW

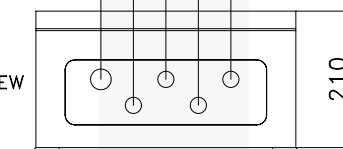

NOTE: typical drawing for control panel

## AIRPORT WINDSOCK COLLAPSIBLE VERSION



Windsocks, also known as wind direction indicators, are important visual aids that each runway must have.

The purpose of these devices is to inform pilots about wind direction and speed, helping them easily and quickly determine weather conditions during landing or taking off phases.



# AIRFIELD LIGHTS

## AIRPORT WINDSOCK COLLAPSIBLE VERSION

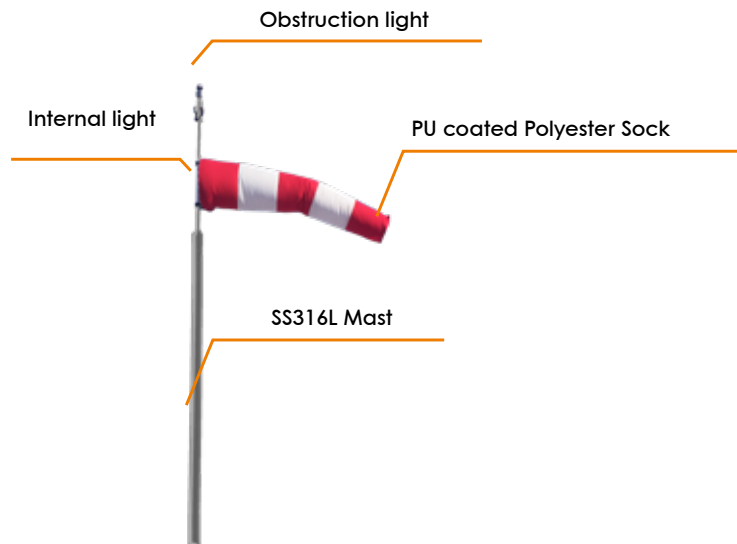

- Sock colour: ORANGE/WHITE/RED&WHITE stripes
- Designed to be visible from up to 200m
- Collapsible mechanism\*
- Compliance: ICAO / EASA

\* Collapsible mechanism: the pole is designed to fall to the ground if hit by an aircraft.

### CERTIFICATION



### COMPLIANCE



### FEATURES

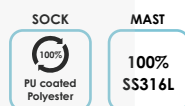

### TYPICAL APPLICATION



# AIRFIELD LIGHTS

## AIRPORT WINDSOCK COLLAPSIBLE VERSION TECHNICAL SPECIFICATIONS

### KEY FEATURES

- **Sock colour:**  
ORANGE/WHITE/RED&WHITE stripes
- Designed to be visible from up to 200m

### MECHANICAL FEATURES

- Sock material: Polyester PU coated
- Sock dimensions: 3,6m long x 0,90m mouth diameter x 0,45m tail diameter
- Mast material: SS316L natural finish (not painted), collapsible mechanism
- Mast height: 6m to windsock centerline

### CERTIFICATIONS

- CE marking

### COMPLIANCE

- ICAO Annex 14
- EASA CS-ADR-DSN

# AIRFIELD LIGHTS

## AIRPORT WINDSOCK COLLAPSIBLE VERSION TECHNICAL DRAWING

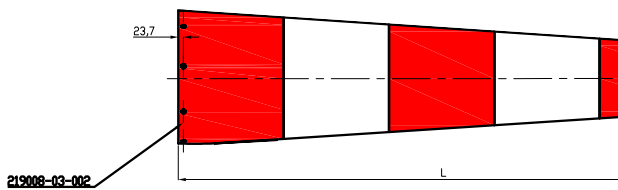

STANDARD WINDSOCK MAST WITH INTERNAL LIGHTING	
Base Plate Measurements	280x280mm
Height of Windsock above Ground	>6m
Windsock Throat Opening	900mm
Windsock Length	3600mm

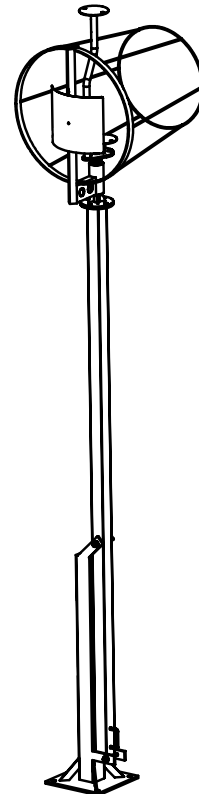
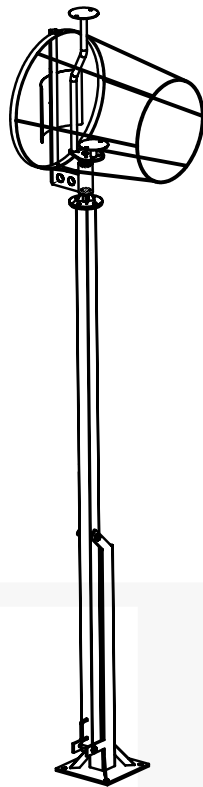



# AERONAUTICAL BEACONS

## PRODUCT LINE TYPICAL INSTALLATION SURFACE LEVEL AERONAUTICAL FAA CONFIGURATION

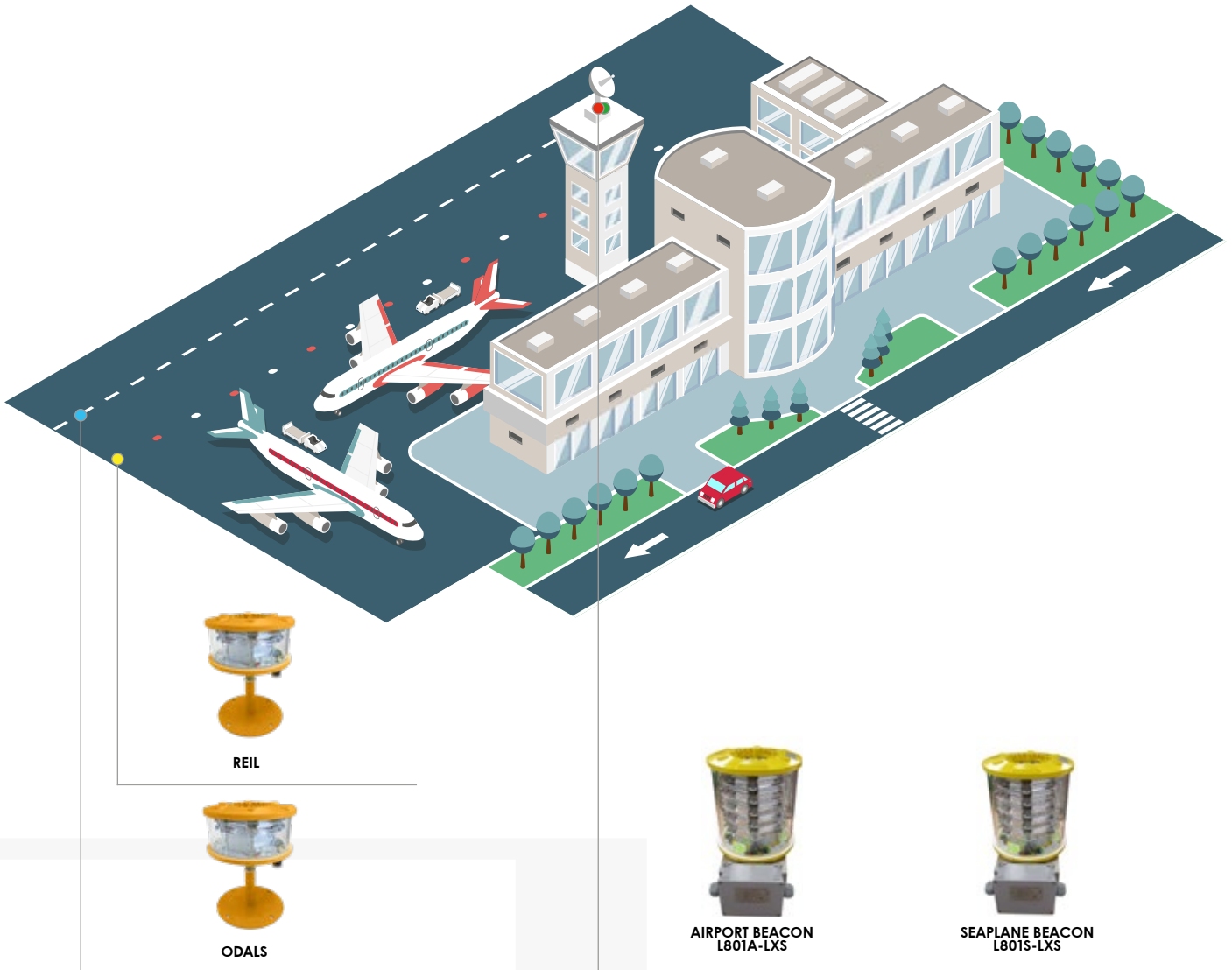

### LEGEND

-  AIRPORT BEACON L801A-LXS
-  OMNI - DIRECTIONAL APPROACH LIGHTING SYSTEM (ODALS)
-  SEAPLANE BEACON L801S-LXS
-  RUNWAY END IDENTIFICATION LIGHTS (REIL)

Image is for informational purposes only.

## OMNI - DIRECTIONAL APPROACH LIGHTING SYSTEM (ODALS)



According to FAA Advisory Circular 150/5345-51, ODALS system is composed by five omni-directional flashing lights installed on extended runway centerline and two REIL omni-directional light installed at each side of runway threshold.

The five lights flash in sequence toward the runway threshold and the two REIL lights flash simultaneously after the last flash of the centerline lights.





# FAA AERONAUTICAL BEACONS

## ODALS

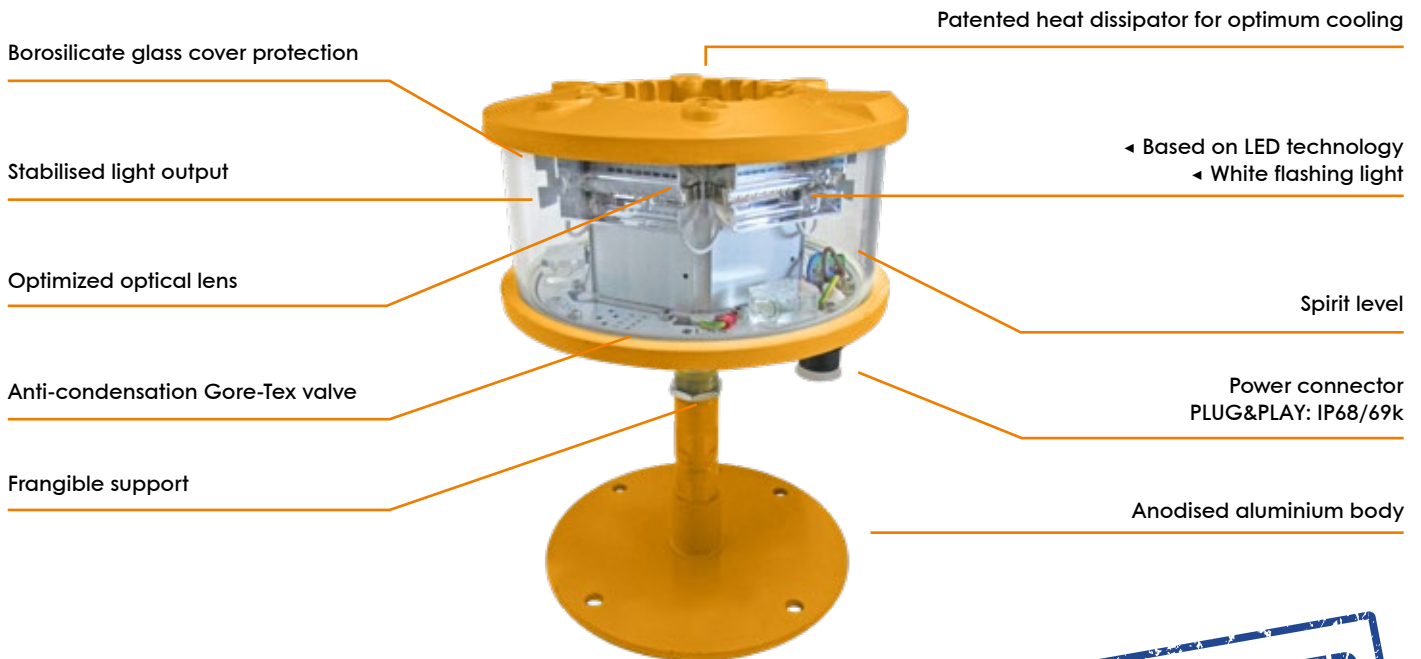

**NOTE: electronic beacon driver in a separate enclosure**

**IP66**



LUXSOLAR L859-LXS ODALS Light is compliant to FAA rule.

With a compact body, high quality and ultra-bright LEDs, customized lenses and patented shape for optimum light emission and beacon cooling LUXSOLAR L859-LXS product is the most up-to-dated and technologically advanced Approach Light Beacon.

This LED device is designed to not contain any electronic component (that is available in a separate control local panel): a huge advantage in terms of increased life-time and suitability to all environments (beacons can stand extreme weather conditions) and in terms of an easy maintenance (in case of maintenance or periodic checks on electronic components, these can be done at ground or easily accessible levels).

### CERTIFICATION



### COMPLIANCE



### FEATURES



### TYPICAL APPLICATION



# FAA AERONAUTICAL BEACONS

## ODALS TECHNICAL SPECIFICATIONS

### OPTICAL FEATURES

- Based on LED technology
- WHITE light
- Three intensity steps: 5.000cd, 1.500cd, 300cd, flashing at @60fpm (style F)
- Horizontal beam radiation 360°
- Vertical beam spread from 2° to 10°
- PMMA lens
- Light output alignment device

### MECHANICAL FEATURES

- Anodised aluminium body, painted yellow
- Borosilicate glass cover protection
- Silicon rubber, VMQ
- Base wind collector and internal heat sink for optimum cooling
- Frangible support
- Degree of protection: IP66
- Operating temperature: -30°C +50°C
- Lamp unit weight: 8kg

### BOX MECHANICAL FEATURES

- Enclosure material: mild steel, painted RAL 7035
- Surge arrester
- Fault alarm
- Photocell (twilight sensor)
- Overvoltage protection

### ELECTRICAL FEATURES

- Suitable for 24Vdc or 115/230Vac power supply by LUXSOLARcontroller box
- LED fed at constant current
- No RF-radiations

### APPLY TO

- Airport runways

### CERTIFICATIONS

- CE marking

### COMPLIANCE

- FAA AC150/5345-51

### PART NUMBER

- L859-LXS-8

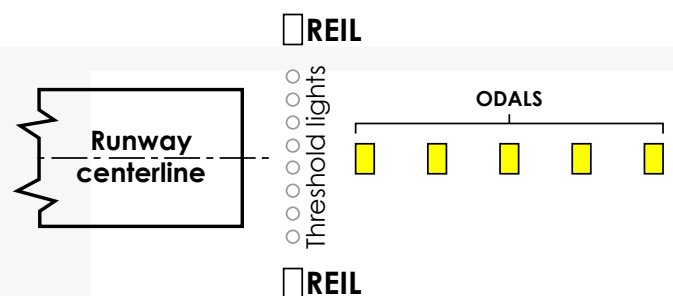

# FAA AERONAUTICAL BEACONS

## ODALS TECHNICAL DRAWING

### BEACON DETAIL

BEACON SIDE VIEW

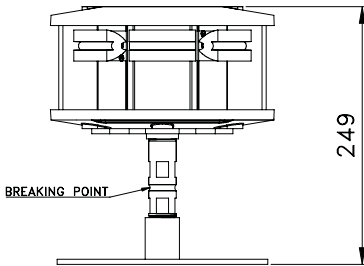

BEACON FRONT VIEW

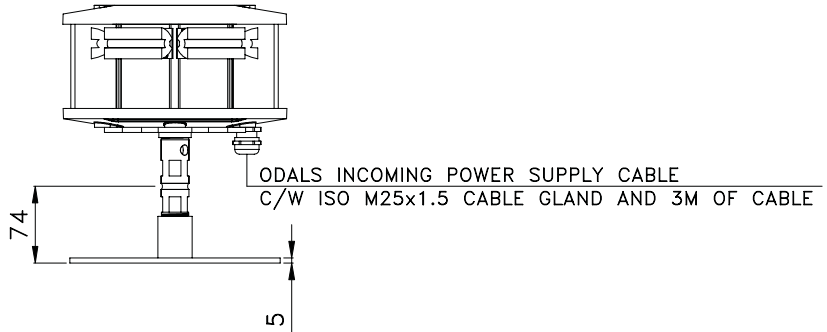

BEACON TOP VIEW

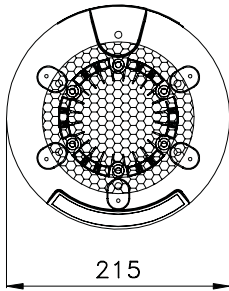

FIXING DETAILS

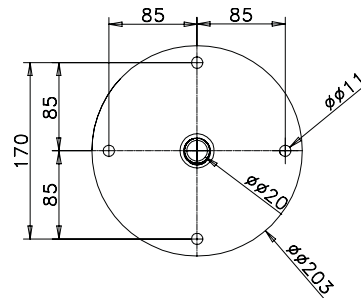

### PANEL DETAIL

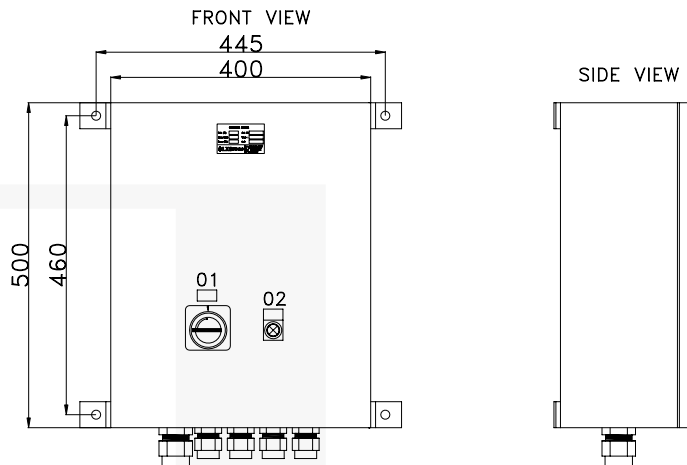

REMOTE COMMAND SIGNALS CABLE  
C/W CABLE GLAND ISO M25x1.5

ALARMS SIGNALS CABLE  
C/W CABLE GLAND ISO M25x1.5

INCOMING POWER SUPPLY CABLE  
C/W CABLE GLAND ISO M32x1.5

REIL-1 BEACON POWER SUPPLY CABLE  
C/W CABLE GLAND ISO M25x1.5

REIL-2 BEACON POWER SUPPLY CABLE  
C/W CABLE GLAND ISO M25x1.5

BOTTOM VIEW

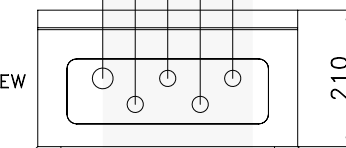

NOTE: typical drawing for control panel

## RUNWAY END IDENTIFICATION LIGHT (REIL)



According to FAA Advisory Circular 150/5345-51, ODALS system is composed by five omni-directional flashing lights installed on extended runway centerline and two REIL omni-directional light installed at each side of runway threshold.

The five lights flash in sequence toward the runway threshold and the two REIL lights flash simultaneously after the last flash of the centerline lights.



# FAA AERONAUTICAL BEACONS

## REIL

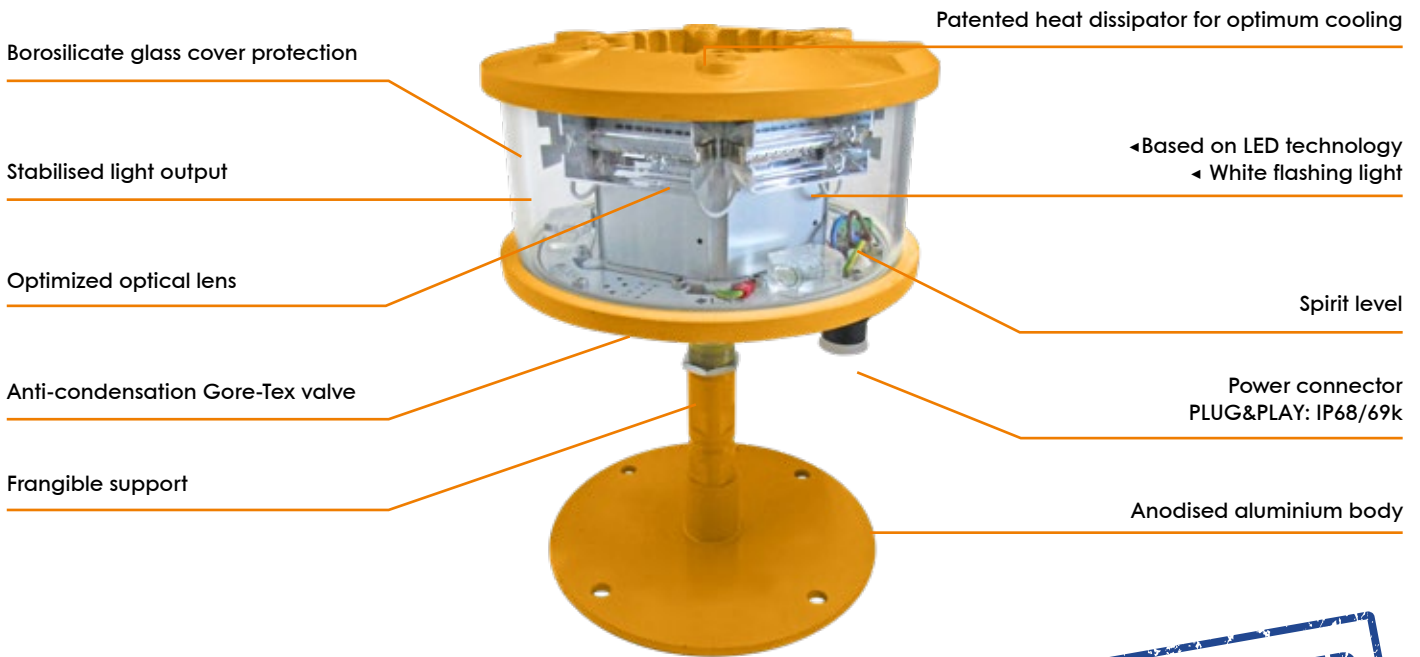

**NOTE: electronic beacon driver in a separate enclosure**

**IP66**



LUXSOLAR L849-LXS REIL Light is compliant to FAA rule.

With a compact body, high quality and ultra-bright LEDs, customized lenses and patented shape for optimum light emission and beacon cooling LUXSOLAR L849-LXS product is the most up-to-dated and technologically advanced Approach Light Beacon.

This LED device is designed to not contain any electronic component (that is available in a separate control local panel): a huge advantage in terms of increased life-time and suitability to all environments (beacons can stand extreme weather conditions) and in terms of an easy maintenance (in case of maintenance or periodic checks on electronic components, these can be done at ground or easily accessible levels).

### CERTIFICATION



### COMPLIANCE



### FEATURES



### TYPICAL APPLICATION



# FAA AERONAUTICAL BEACONS

## REIL TECHNICAL SPECIFICATIONS

### OPTICAL FEATURES

- Based on LED technology
- WHITE light
- High intensity: 5.000cd, flashing at @60fpm (Style B)
- Low intensity: 700cd, flashing at @120fpm (Style D)
- Three intensity steps: 5.000cd, 1.500cd, 300cd, flashing at @60fpm (Style F)
- Horizontal beam radiation 360°
- Vertical beam spread from 2° to 10°
- PMMA lens
- Light output alignment device

### MECHANICAL FEATURES

- Anodised aluminium body, painted yellow
- Borosilicate glass cover protection
- Silicon rubber, VMQ
- Base wind collector and internal heat sink for optimum cooling
- Frangible support
- Degree of protection: IP66
- Operating temperature: -30°C +50°C
- Lamp unit weight: 8kg

### BOX MECHANICAL FEATURES

- Enclosure material: mild steel, painted RAL 7035
- Surge arrester
- Fault alarm
- Photocell (twilight sensor)
- Overvoltage protection

### ELECTRICAL FEATURES

- Suitable for 24Vdc or 115/230Vac power supply by LUXSOLARcontroller box
- LED feeded at constant current
- No RF-radiations

### APPLY TO

- ODALS system uses seven omni-directional flashing light, five are installed on an extended runway centerline and two are installed in a REIL configuration flashing simultaneously after the last flash of the centerline lights ; this lighting system is an aid for pilots that need to determine which runway is in use.

### CERTIFICATIONS

- CE marking

### COMPLIANCE

- FAA AC150/5345-51

### PART NUMBER

- L849-LXS-8

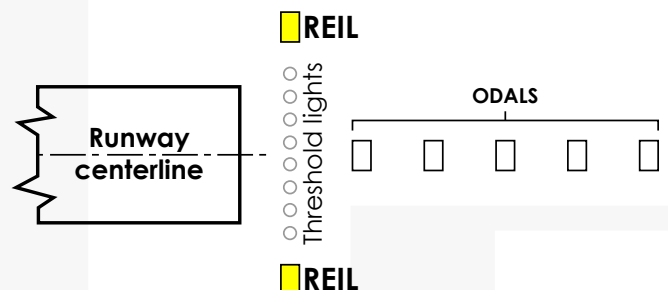

# FAA AERONAUTICAL BEACONS

## REIL TECHNICAL DRAWING

### BEACON DETAIL

BEACON SIDE VIEW

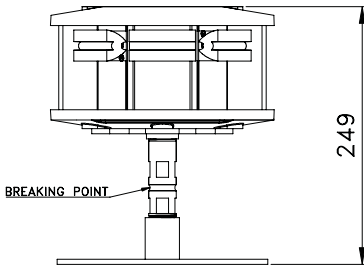

BEACON FRONT VIEW

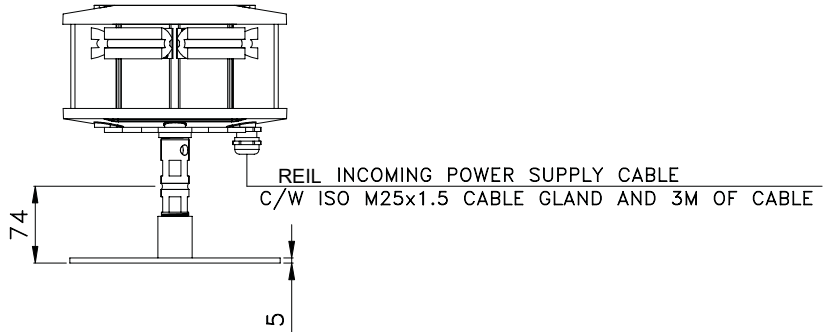

BEACON TOP VIEW

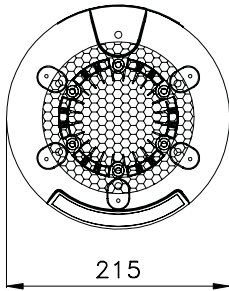

FIXING DETAILS

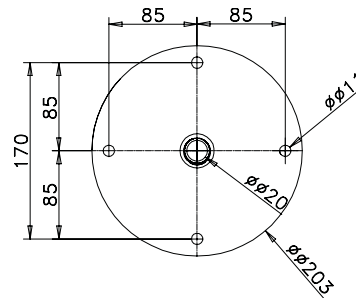

### PANEL DETAIL

FRONT VIEW

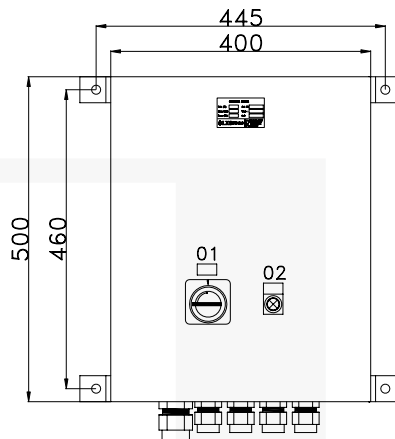

SIDE VIEW

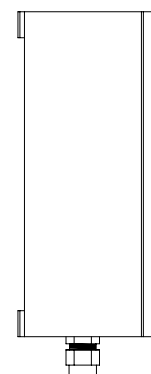

REMOTE COMMAND SIGNALS CABLE  
C/W CABLE GLAND ISO M25x1.5

ALARMS SIGNALS CABLE  
C/W CABLE GLAND ISO M25x1.5

INCOMING POWER SUPPLY CABLE  
C/W CABLE GLAND ISO M32x1.5

REIL-1 BEACON POWER SUPPLY CABLE  
C/W CABLE GLAND ISO M25x1.5

REIL-2 BEACON POWER SUPPLY CABLE  
C/W CABLE GLAND ISO M25x1.5

BOTTOM VIEW

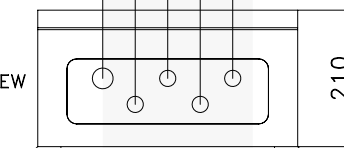

NOTE: typical drawing for control panel

## AIRPORT BEACONS MEDIUM INTENSITY L801A-LXS



According to FAA AC150/5345-12, an L801A Aeronautical Beacons should be provided at airports intended for use at night.

L801A Beacon shall be provided where the airport, due to the location or high background luminance, cannot be easily identified from the air by other identification means.

The device displays alternate white/green flashing light with 22-26 flashes per minute.





# FAA AERONAUTICAL BEACONS

## AIRPORT BEACONS MEDIUM INTENSITY L801A-LXS

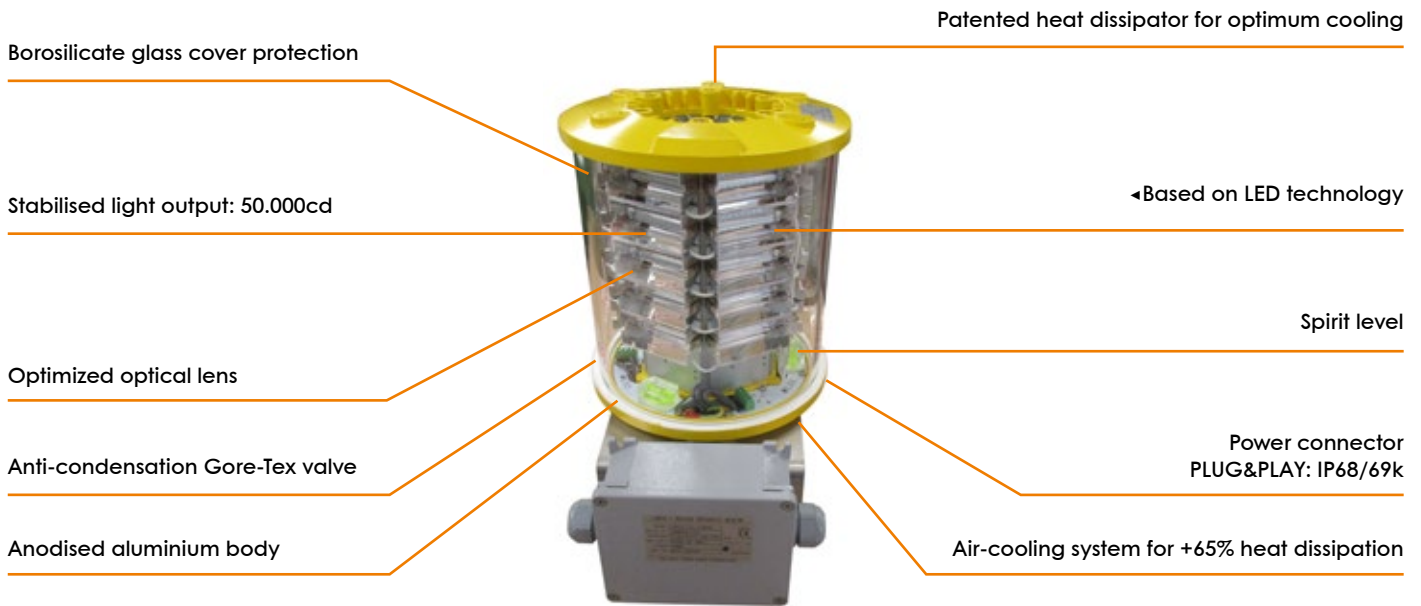

**NOTE: electronic beacon driver in a separate enclosure**

**IP66**



LUXSOLAR L801A-LXS Seaplane Aeronautical Aerodrome Beacon is compliant to FAA rule.

With high quality and ultra-bright LEDs, customized lenses and patented shape for optimum light emission and beacon cooling LUXSOLAR L801A-LXS product is the most up-to-dated and technologically advanced Aeronautical Beacon.

This LED device is designed to not contain any electronic component (that is available in a separate control local panel): a huge advantage in terms of increased life-time and suitability to all environments (beacons can stand extreme weather conditions) and in terms of an easy maintenance (in case of maintenance or periodic checks on electronic components, these can be done easily).

### CERTIFICATION



### COMPLIANCE



### FEATURES

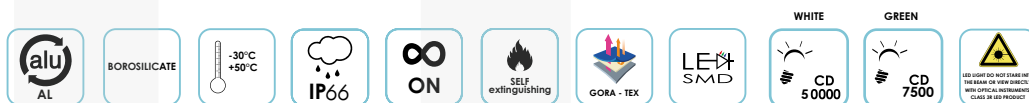

### TYPICAL APPLICATION



## AIRPORT BEACONS MEDIUM INTENSITY L801A-LXS TECHNICAL SPECIFICATIONS

### OPTICAL FEATURES

- Based on LED technology
- 50.000cd WHITE light / 7.500cd GREEN light - Flashing 22-26fpm
- Horizontal beam radiation 360°
- Vertical beam spread from -3° to +7°
- PMMA lens
- Light output alignment device

### MECHANICAL FEATURES

- Anodised aluminium body, painted yellow
- Borosilicate glass cover protection
- Silicon rubber, VMQ
- Base wind collector and internal heat sink for optimum cooling
- Degree of protection: IP66
- Anti-condensation Gore-Tex valve
- Operating temp.: -30°C to +50°C
- Lamp unit weight: 8kg approx.

### BOX MECHANICAL FEATURES

- Enclosure material: mild steel, painted RAL 7035
- Surge arrester
- Fault alarm
- Overvoltage protection

### ELECTRICAL FEATURES

- Power supply by LUXSOLAR controller box
- Suitable for 24Vdc or 115/230Vac power supply
- LED feeded at constant current
- No RF - Radiations

### OPTIONS

- Beacon support bracket
- GPS (Global Position System) syncro

### APPLY TO

- Airports intended for use at night and that can not be easily identified from the air by other means.

### CERTIFICATIONS

- CE marking

### COMPLIANCE

- FAA AC150/5345-12 lamp type L-801A

### PART NUMBER

- L801A-LXS-230VAC
- L801A-LXS-24VDC

# FAA AERONAUTICAL BEACONS

## AIRPORT BEACONS MEDIUM INTENSITY L801A-LXS TECHNICAL DRAWING

L801A  
BEACON

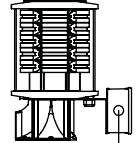

L801A BEACON POWER SUPPLY CABLE  
11G1.5sqmm (BY OTHERS)

AWL CONTROL PANEL

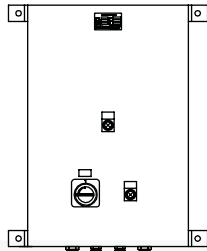

INCOMING POWER SUPPLY CABLE  
(BY OTHERS)

REMOTE ENABLE SIGNAL CABLE  
(BY OTHERS)

FAULT SIGNALS CABLE  
(BY OTHERS)

# FAA AERONAUTICAL BEACONS

## AIRPORT BEACONS MEDIUM INTENSITY L801A-LXS TECHNICAL DRAWING

RIGHT SIDE VIEW

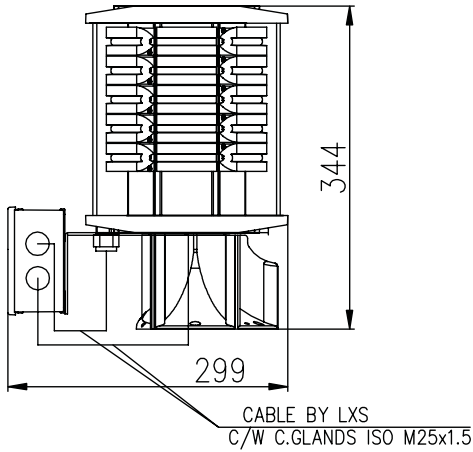

LEFT SIDE VIEW

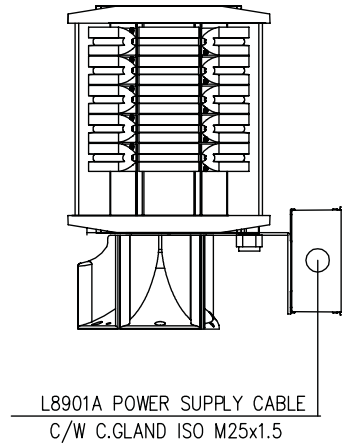

FRONT VIEW

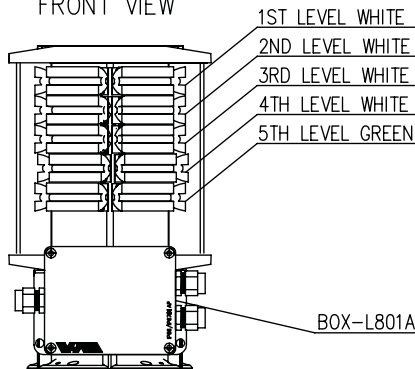

TOP VIEW

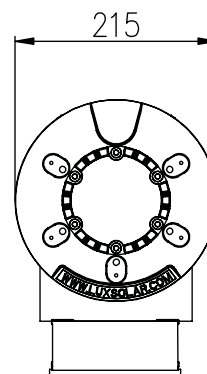

FIXING DETAILS

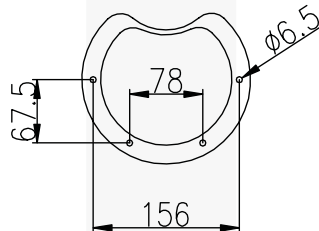

# FAA AERONAUTICAL BEACONS

## AIRPORT BEACONS MEDIUM INTENSITY L801A-LXS TECHNICAL DRAWING

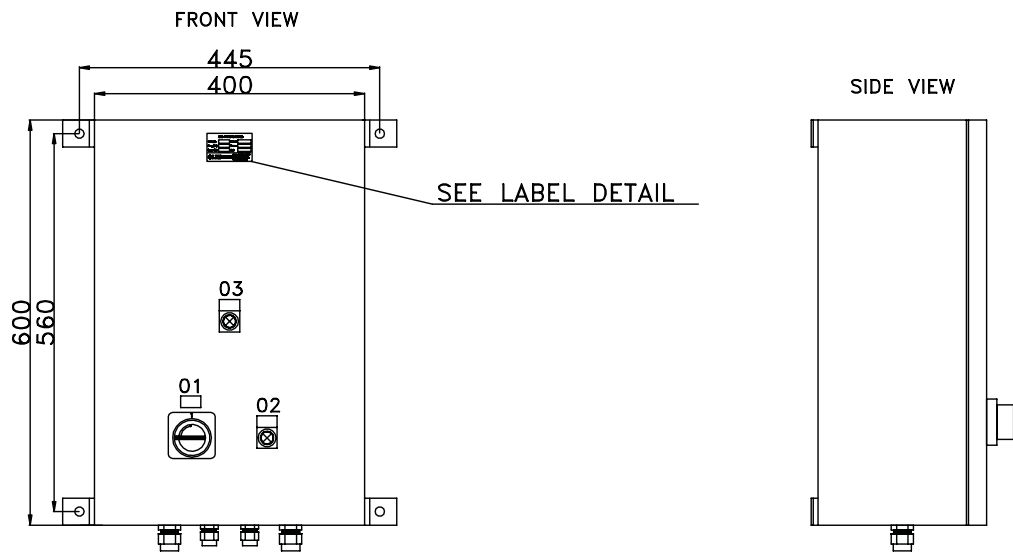

INCOMING POWER SUPPLY CABLE  
C/W CABLE GLAND ISO M25x1.5

BOTTOM VIEW

REMOTE ENABLE SIGNAL CABLE  
C/W CABLE GLAND ISO M20x1.5

FAULT SIGNALS CABLE  
C/W CABLE GLAND ISO M20x1.5

L801A POWER SUPPLY CABLE  
C/W CABLE GLAND ISO M25x1.5

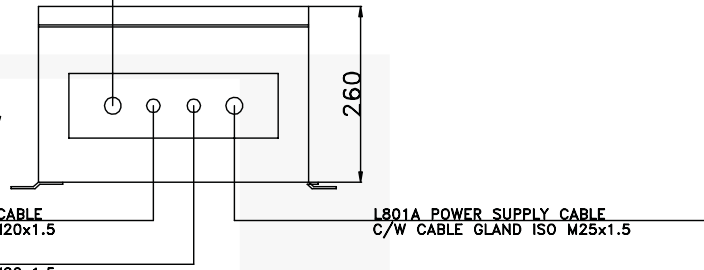

## AIRPORT BEACONS MEDIUM INTENSITY L802A-LXS



According to FAA AC150/5345-12, an L802A Aeronautical Beacons should be provided at airports intended for use at night.

L802A beacon shall be provided where the airport, due to the location or high background luminance, cannot be easily identified from the air by other identification means.

The device displays alternate white/green flashing light with 22-26 flashes per minute.



# FAA AERONAUTICAL BEACONS

## AIRPORT BEACONS MEDIUM INTENSITY L802A-LXS

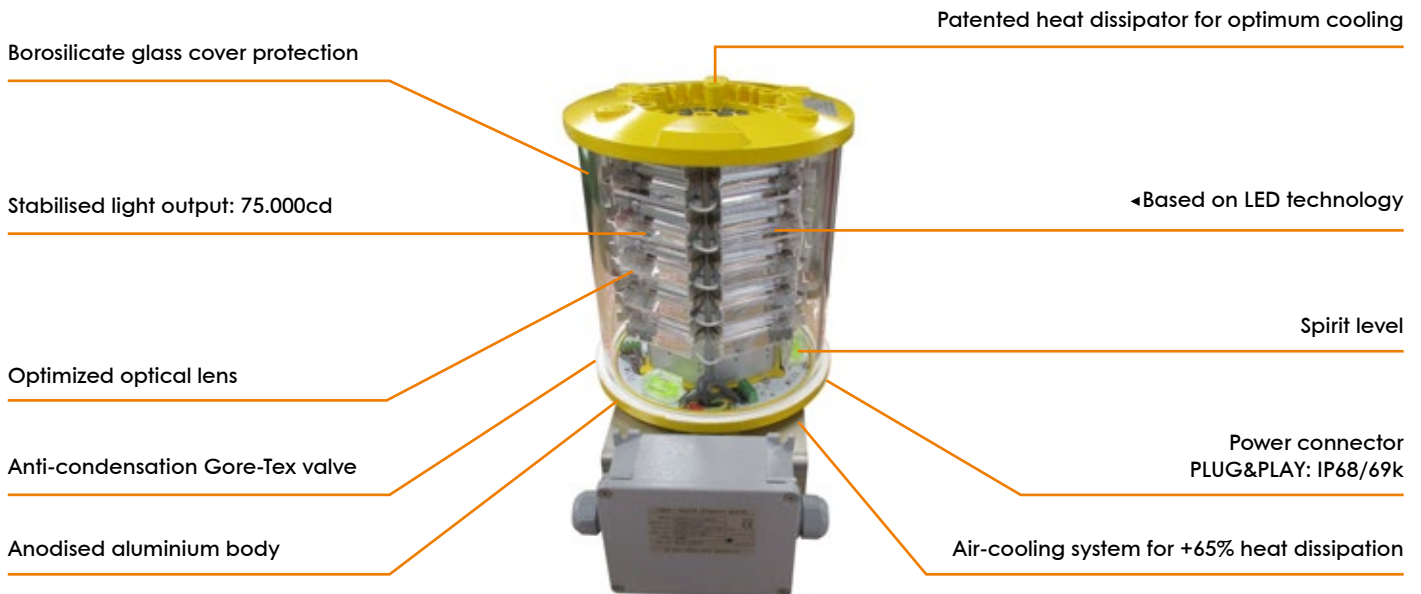

**NOTE: ELECTRONIC BEACON DRIVER IN A SEPARATE ENCLOSURE**

**IP66**



LUXSOLAR L802A-LXS Seaplane Aeronautical Aerodrome Beacon is compliant to FAA rule.

With high quality and ultra-bright LEDs, customized lenses and patented shape for optimum light emission and beacon cooling LUXSOLAR L802A-LXS product is the most up-to-dated and technologically advanced Aeronautical Beacon.

This LED device is designed to not contain any electronic component (that is available in a separate control local panel): a huge advantage in terms of increased life-time and suitability to all environments (beacons can stand extreme weather conditions) and in terms of an easy maintenance (in case of maintenance or periodic checks on electronic components, these can be done easily).

### CERTIFICATION



### COMPLIANCE



### FEATURES



### TYPICAL APPLICATION



# FAA AERONAUTICAL BEACONS

## AIRPORT BEACONS MEDIUM INTENSITY L802A-LXS TECHNICAL SPECIFICATIONS

### OPTICAL FEATURES

- Based on LED technology
- 75.000cd WHITE light / 11.250cd GREEN light - Flashing 22-26fpm
- Horizontal beam radiation 360°
- Vertical beam spread from -3° to +7°
- PMMA lens
- Light output alignment device

### MECHANICAL FEATURES

- Anodised aluminium body, painted yellow
- Borosilicate glass cover protection
- Silicon rubber, VMQ
- Base wind collector and internal heat sink for optimum cooling
- Degree of protection: IP66
- Anti-condensation Gore-Tex valve
- Operating temp.: -30°C to +50°C
- Lamp unit weight: 8kg approx.

### BOX MECHANICAL FEATURES

- Enclosure material: mild steel, painted RAL 7035
- Surge arrester
- Fault alarm
- Overvoltage protection

### ELECTRICAL FEATURES

- Power supply by LUXSOLAR controller box
- Suitable for 24Vdc or 115/230Vac power supply
- LED feeded at constant current
- No RF - Radiations

### OPTIONS

- Beacon support bracket
- GPS (Global Position System) syncro

### APPLY TO

- Airports intended for use at night and that can not be easily identified from the air by other means.

### CERTIFICATIONS

- CE marking

### COMPLIANCE

- FAA AC150/5345-12 lamp type L-802A

### PART NUMBER

- L802A-LXS-230VAC
- L802A-LXS-24VDC



# FAA AERONAUTICAL BEACONS

## AIRPORT BEACONS MEDIUM INTENSITY L802A-LXS TECHNICAL DRAWING

L802A  
BEACON

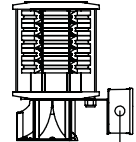

L801A BEACON POWER SUPPLY CABLE  
11G1.5sqmm (BY OTHERS)

AWL CONTROL PANEL

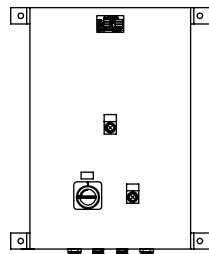

INCOMING POWER SUPPLY CABLE  
(BY OTHERS)

REMOTE ENABLE SIGNAL CABLE  
(BY OTHERS)

FAULT SIGNALS CABLE  
(BY OTHERS)

## SEAPLANE AIRPORT LIGHT BEACON MEDIUM INTENSITY L801S-LXS



According to FAA AC150/5345-12, an L801S Seaplane Aeronautical Beacons should be provided at sea-based airports intended for use at night.

L801S Beacon shall be provided where the airport, due to the location or high background luminance, cannot be easily identified from the air by other identification means.

The device displays alternate white/yellow flashing light with 22-26 flashes per minute.



# FAA AERONAUTICAL BEACONS

## SEAPLANE AIRPORT BEACON MEDIUM INTENSITY L801S-LXS

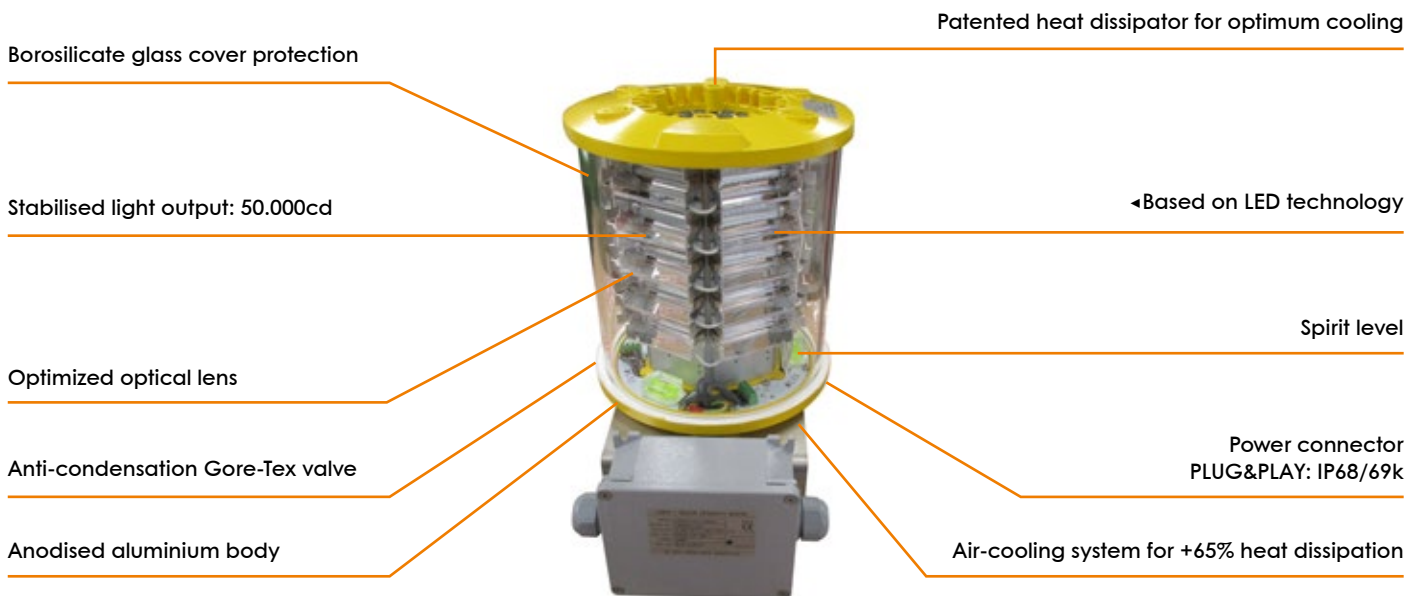

**NOTE: ELECTRONIC BEACON  
DRIVER IN A SEPARATE ENCLOSURE**

**IP66**

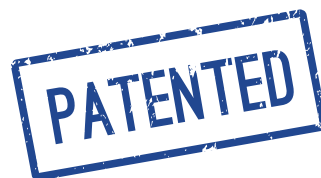

LUXSOLAR L801S-LXS Seaplane Aeronautical Aerodrome Beacon is compliant to FAA rule.

With high quality and ultra-bright LEDs, customized lenses and patented shape for optimum light emission and beacon cooling LUXSOLAR L801S-LXS product is the most up-to-dated and technologically advanced Aeronautical Beacon.

This LED device is designed to not contain any electronic component (that is available in a separate control local panel): a huge advantage in terms of increased life-time and suitability to all environments (beacons can stand extreme weather conditions) and in terms of an easy maintenance (in case of maintenance or periodic checks on electronic components, these can be done easily).

### CERTIFICATION



### COMPLIANCE



### FEATURES



### TYPICAL APPLICATION



# FAA AERONAUTICAL BEACONS

## SEAPLANE AIRPORT BEACON MEDIUM INTENSITY L801S-LXS TECHNICAL SPECIFICATIONS

### OPTICAL FEATURES

- Based on LED technology
- 50.000cd WHITE light / 20.000cd YELLOW light - Flashing 22-26fpm
- Horizontal beam radiation 360°
- Vertical beam spread from -3° to +7°
- PMMA lens
- Light output alignment device

### MECHANICAL FEATURES

- Anodised aluminium body, painted yellow
- Borosilicate glass cover protection
- Silicon rubber, VMQ
- Base wind collector and internal heat sink for optimum cooling
- Degree of protection: IP66
- Anti-condensation Gore-Tex valve
- Operating temp.: -30°C to +50°C
- Lamp unit weight: 8kg approx.

### BOX MECHANICAL FEATURES

- Enclosure material: mild steel, painted RAL 7035
- Surge arrester
- Fault alarm
- Overvoltage protection

### ELECTRICAL FEATURES

- Power supply by LUXSOLAR controller box
- Suitable for 24Vdc or 115/230Vac power supply
- LED feeded at constant current
- No RF - Radiations

### OPTIONS

- Beacon support bracket
- GPS (Global Position System) syncro

### APPLY TO

- Airports intended for use at night and that can not be easily identified from the air by other means.

### CERTIFICATIONS

- CE marking

### COMPLIANCE

- FAA AC150/5345-12 lamp type L-801S

### PART NUMBER

- L801S-LXS-230VAC
- L801S-LXS-24VDC

# FAA AERONAUTICAL BEACONS

## SEAPLANE AIRPORT BEACON MEDIUM INTENSITY L801S-LXS TECHNICAL DRAWING

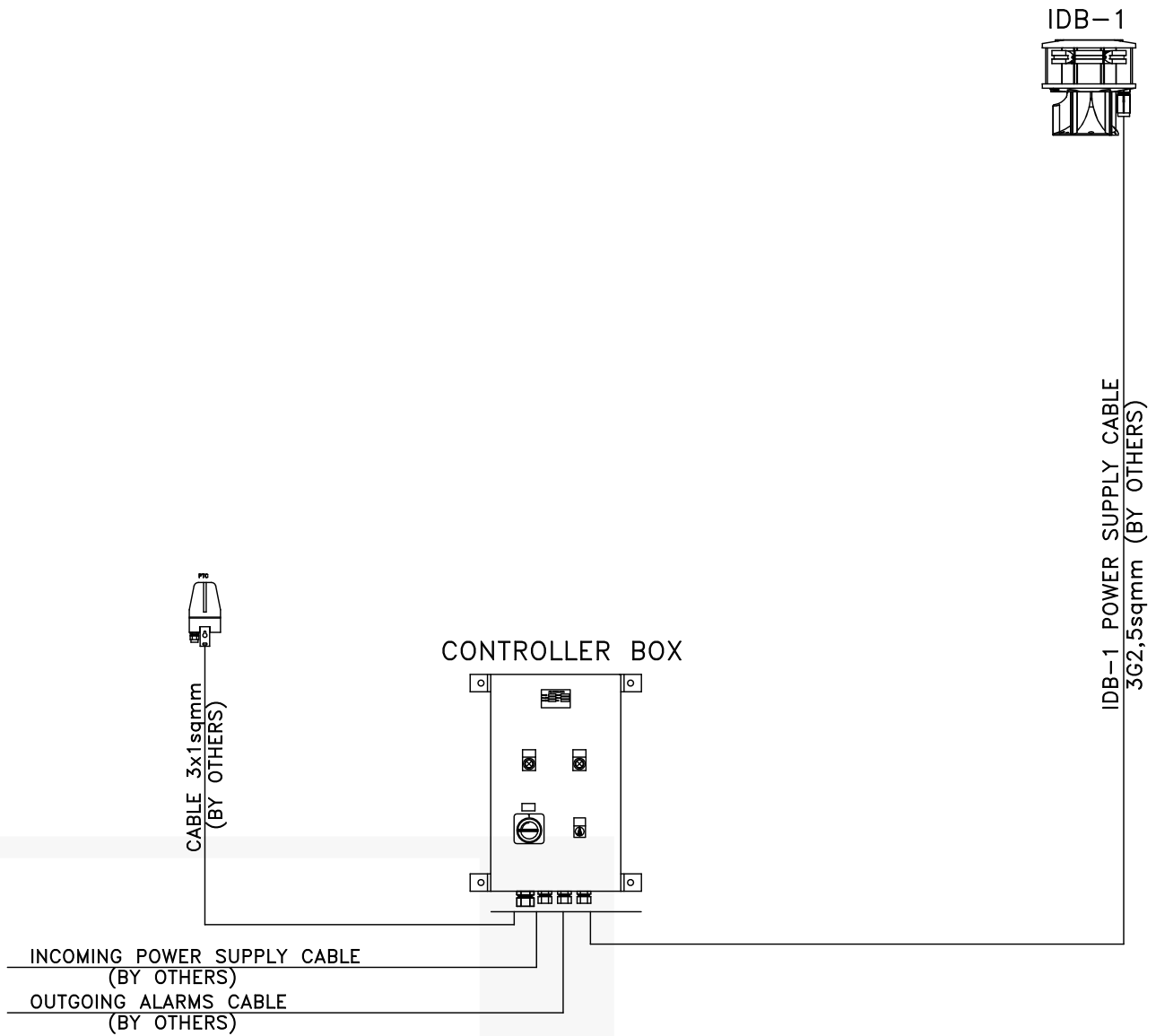

# FAA AERONAUTICAL BEACONS

## SEAPLANE AIRPORT BEACON MEDIUM INTENSITY L801S-LXS TECHNICAL DRAWING

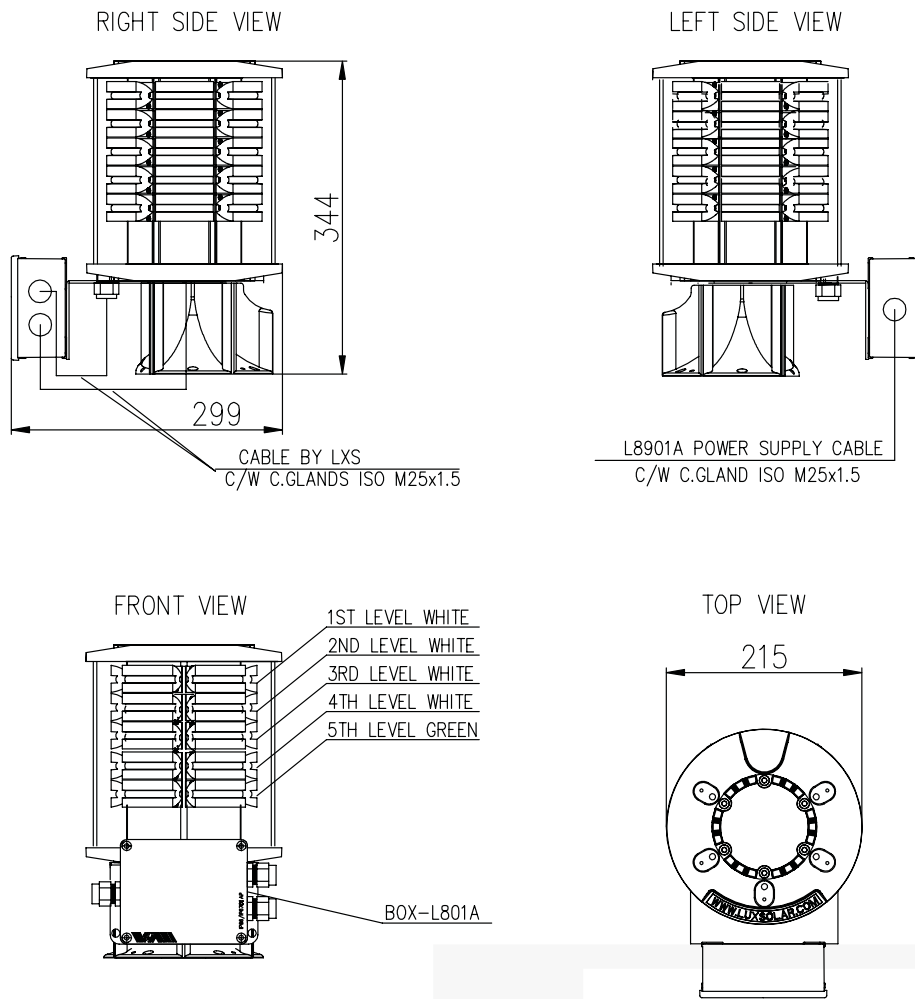

### FIXING DETAILS

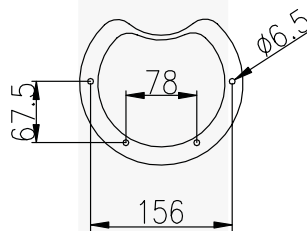

# FAA AERONAUTICAL BEACONS

## SEAPLANE AIRPORT BEACON MEDIUM INTENSITY L801S-LXS TECHNICAL DRAWING

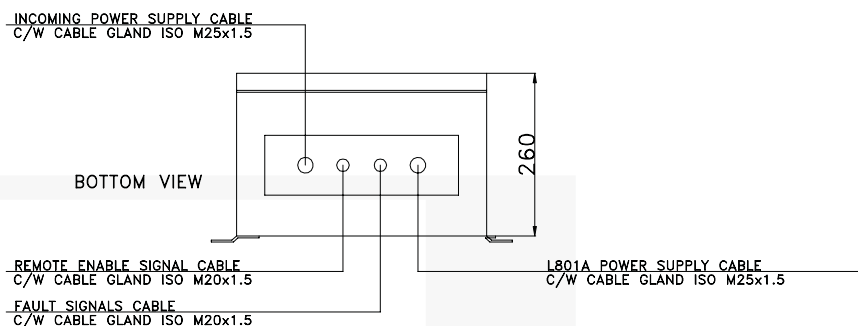
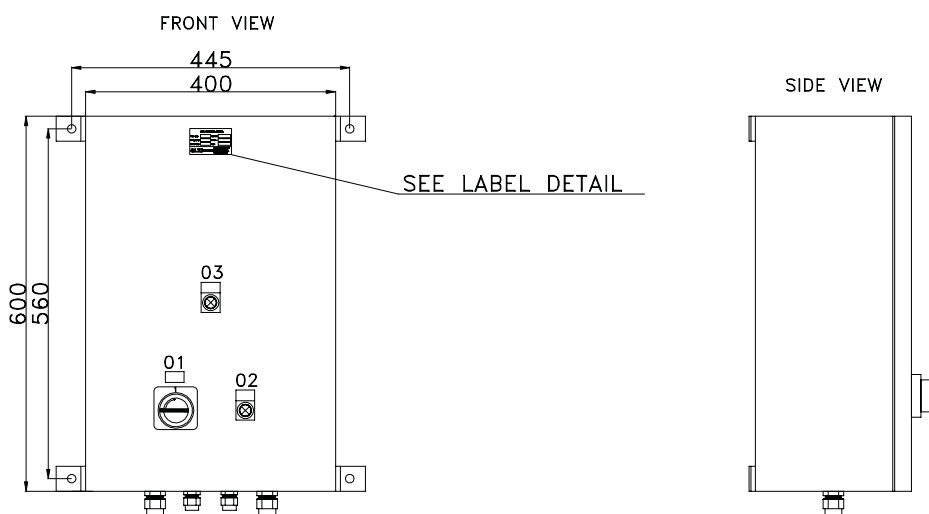









# CONTACTS

## **CE2K S.r.l. - Luxsolar®**

---

**Phone: +39 0341-260926**

**E-mail: [info@ce2k.com](mailto:info@ce2k.com) - [lx@luxsolar.com](mailto:lx@luxsolar.com)**

**Web sites: [www.ce2k.com](http://www.ce2k.com) - [www.luxsolar.com](http://www.luxsolar.com)**

- LinkedIn: Luxsolar Italia



- YouTube: Luxsolar





LUXSOLAR® is a department of CE2K S.r.l.  
Via Sabatelli 38, 23868 Valmadrera (LC) - Italy



[www.luxsolar.com](http://www.luxsolar.com)